

**1200**  
**FIBER COMPOSITE**  
**CARBON SHELL**  
**SERIES**

E13\*22R00\*22R05\*0392\*02

Version:1.2

# 1200

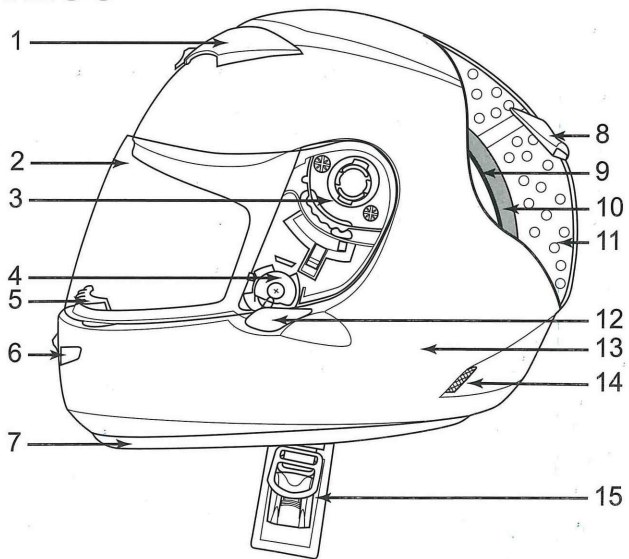

- |                     |                     |
|---------------------|---------------------|
| 1. TOP VENT         | 9. FABRRIC          |
| 2. VISOR            | 10. SPONGE          |
| 3. VISOR MECHANISM  | 11. EPS             |
| 4. LOCKING PLATE    | 12. VISOR PLATE     |
| 5. INNER CHIN VENT  | 13. OUTER SELL      |
| 6. CHIN VENT        | 14. LOWER REAR VENT |
| 7. NECK RUBBER TRIM | 15. CHIN STRAP      |
| 8. REAR VENT        |                     |

# 1200A

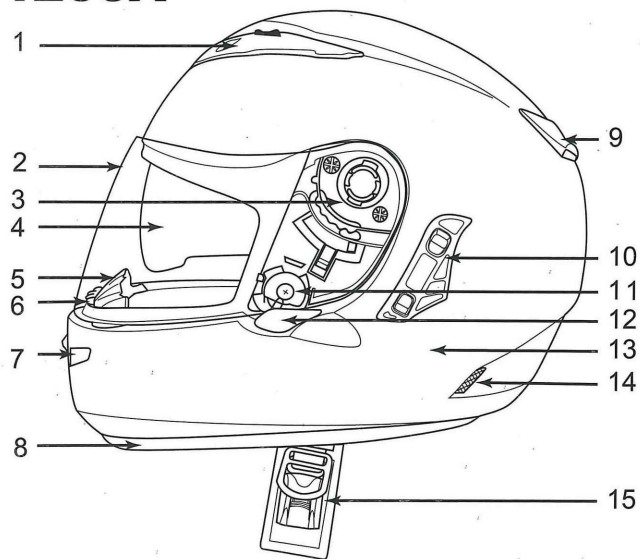

- |                     |                      |
|---------------------|----------------------|
| 1. TOP VENT         | 9. REAR VENT         |
| 2. VISOR            | 10. SUN VISOR BUTTON |
| 3. VISOR MECHANISM  | 11. LOCKING PLATE    |
| 4. SUN VISOR        | 12. VISOR PLATE      |
| 5. WIND DEFLECTOR   | 13. OUTER SELL       |
| 6. INNER CHIN VENT  | 14. LOWER REAR VENT  |
| 7. CHIN VENT        | 15. CHIN STRAP       |
| 8. NECK RUBBER TRIM |                      |

# 1200E - FIBER COMPOSITE/CARBON SHELL

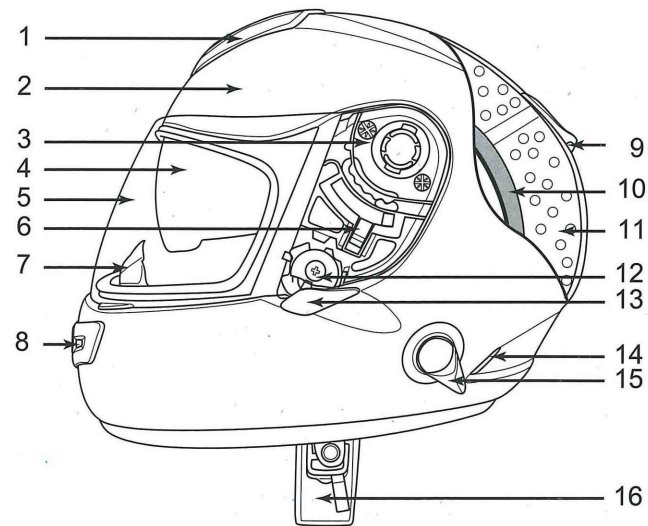

- |                    |                      |
|--------------------|----------------------|
| 1. TOP VENT        | 9. REAR VENT         |
| 2. OUTER SHELL     | 10. SPONGE           |
| 3. VISOR MECHANISM | 11. EPS              |
| 4. SUN VISOR       | 12. LOCKING PLATE    |
| 5. VISOR           | 13. VISOR PLATE      |
| 6. VISOR LOCKER    | 14. LOWER REAR VENT  |
| 7. WIND DEFLECTOR  | 15. SUN VISOR BUTTON |
| 8. CHIN VENT       | 16. CHIN STRAP       |

## Visor removal

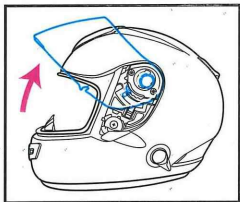

1. Open visor completely.

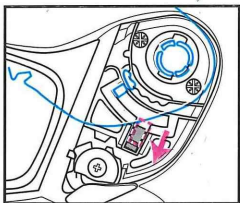

2. Open gate by sliding locks downwards on both visor base plates.

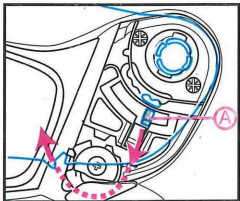

3. Lower visor downwards till (A) point to the upper position of the visor locker. Grasp visor with both hands and then flex visor outwards.

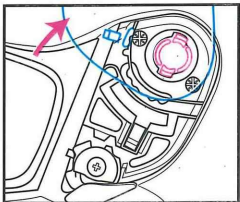

4. Open visor completely till the tenons out of the both sides of visor and then flex visor outwards.

## Visor Installation

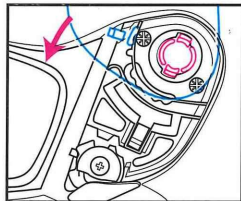

1. Line up the tenons on the both sides of visor with the fillisters of visor gates, press inwards.

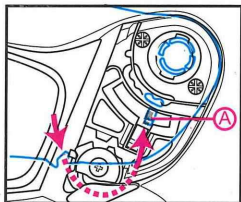

2. Lower visor downwards till (A) points on both sides to the upper position of the visor locker and press both the two sides of visor inwards to secure visor, then open visor to maximum opening.

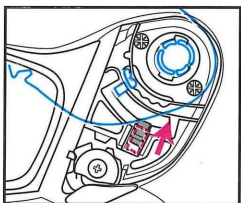

3. Push both the visor stoppers upwards.

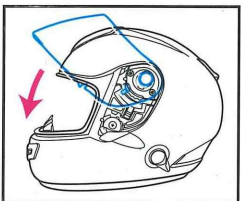

4. Visor may now be closed.

## 1200E Sun Visor Removal

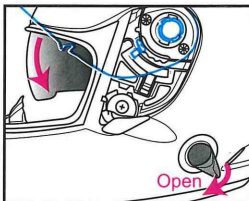

1. Open visor to its full open position. Push forward the sun visor button and sun visor will be automatically laid down.

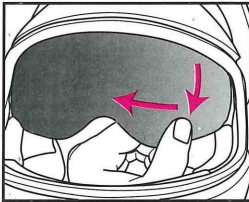

2. Pull downwards the left hand side of the sun visor in order to have a small vacant space. Then pull outward the sun visor to remove from mechanism.

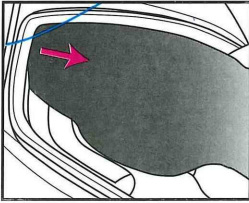

3. Repeat on opposite side.

## 1200E Sun Visor Installation

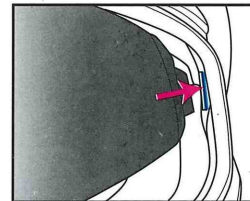

1. Push the sun visor in the direction of the arrow until the main visor axis stops within the mechanism.(blue highlight)

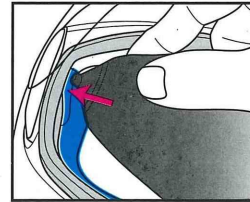

2. Repeat on the right hand side.

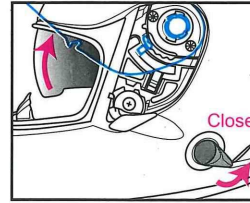

3. Press the sun visor button to retrieve the sun visor into the shell and install the wind deflector accordingly.

## Visor removal

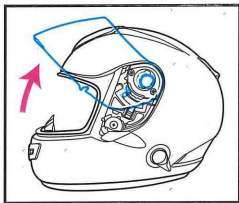

1. Open visor completely.

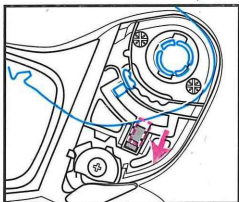

2. Open gate by sliding locks downwards on both visor base plates.

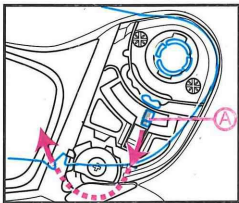

3. Lower visor downwards till (A) point to the upper position of the visor locker. Grasp visor with both hands and then flex visor outwards.

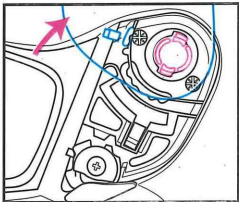

4. Open visor completely till the tenons out of the both sides of visor and then flex visor outwards.

## Introduction of "Removable Lining"

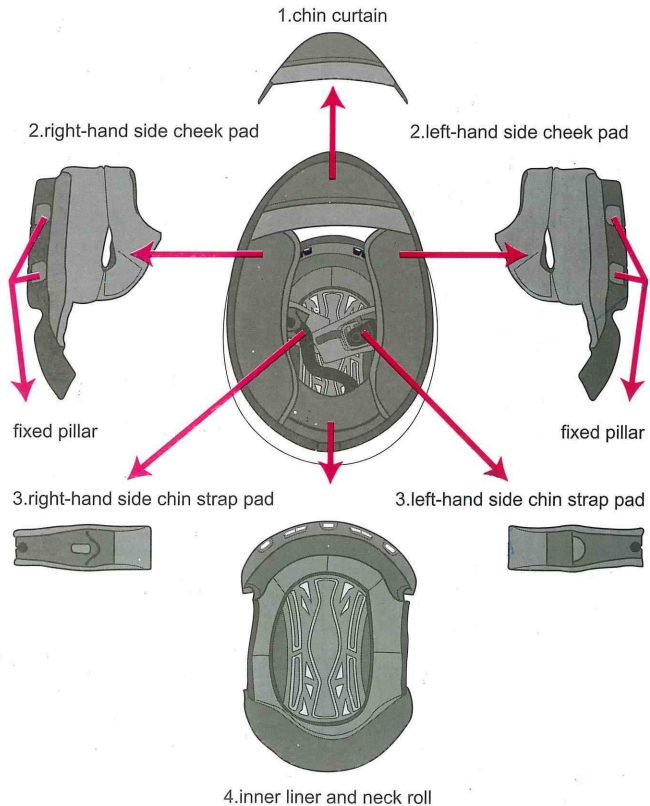

※ The removal flow from 1→4

※ The installation flow from 1→4

## Visor Locking system Instruction

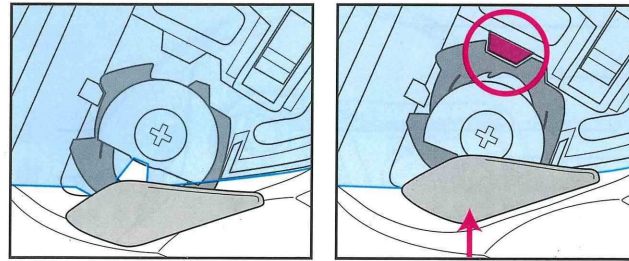

1. Visor Plate at normal position.

2. Push the plate upwards.

### → To open the visor

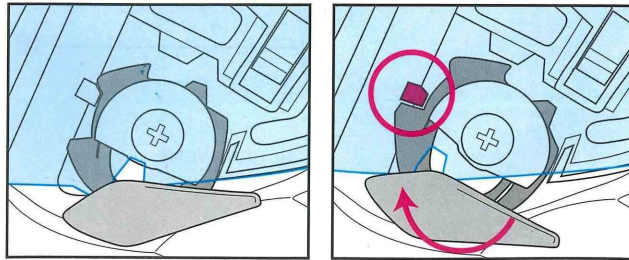

1. Visor Plate at normal position.

2. Turn the plate at clock wise direction

## 1200A Manipulation Indication of front top vent

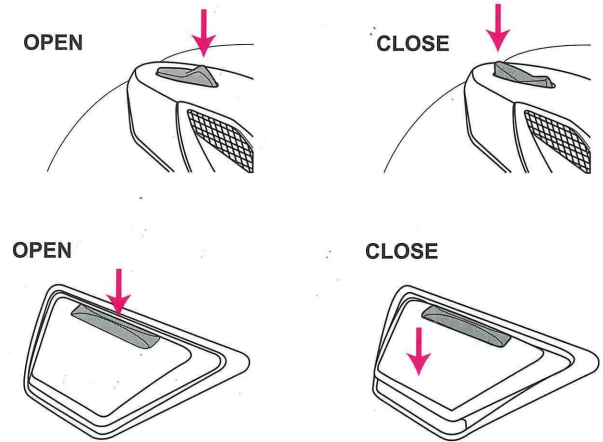

## 1200E Manipulation Indication of front top vent

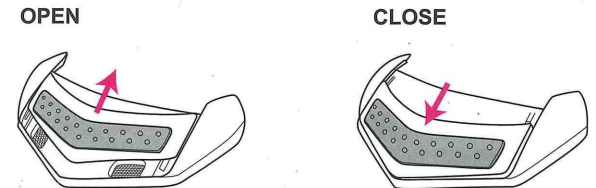

## Indication of "cheek pads" for removal and installation

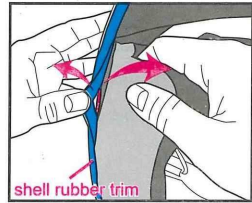

1. Grasp the shell rubber trim, then remove the PE board of cheek pad liner from the shell.

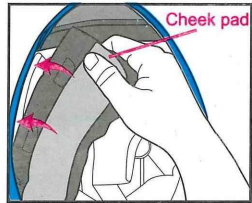

2. Put the PE board of new cheek pad liner and insert into the shell & cheek pad EPS in between.

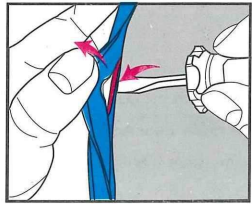

3. Adjust the position of cheek pad liner, grasp the shell rubber trim, then tool in order to fix all the PE board into the interior shell rubber trim.

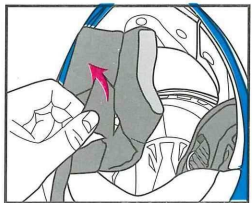

4. Put the chin strap into the holes of cheek pad liner.

## Indication of "cheek pads" for removal and installation

5. Fix the three buttons of cheek pad liner.

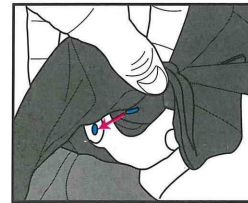
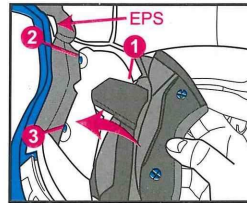

## Indication of "chin curtain" for removal and installation

※ It will be more smoothly if you pulled open the neck rubber trim slightly when dismantling or assembling these 2 parts.

### Removal portion:

- ◎ Pull the chin curtain upwards from one side.

### Installation portion:

- A. Line up the clasp of the chin curtain with the front middle position of the helmet.
- B. Then slide the clasp of one side into the seam between the outer shell and PU chin. Later get the clasps inner-press till the neck rubber trim completely covers the clasps.

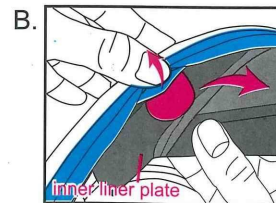
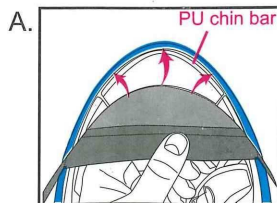

## Indication of "Inner Lining" for removal&installation

※ Prior to remove the inner lining, must take off the both sides of cheek pads lining first.

### Removal portion:

1. Remove the neck padding from EPS.
2. Then pull outward the front top padding from the fixed board.

### Installation portion:

- A. Put the inner lining properly on the top of EPS, then press the fixed buttons into the back of EPS (blue highlight).
- B. Push the front top padding into the fixed board.
- C. Insert the both sides fixed board of front lining between the shell and EPS.

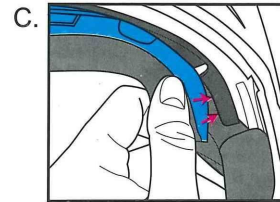
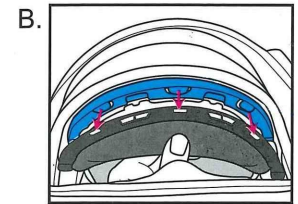
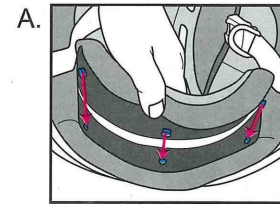

## Indication of "chin strap pads" for removal and installation

### Removal portion:

- ※ Before removal, firstly remove the cheek pads.
- ◎ Then hold the slit of the chin strap curtain which is near the EPS, and draw out the chin strap pad.

### Installation portion:

- ◎ Indicate the direction of chin strap curtain, pass through the chin strap, and push the strap to the bottom, then stick it.

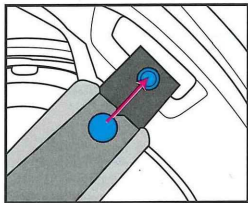

## Notification:

1. Please use water or neutral cleanser to clean the visor or liner.
2. Suggested to wash the liner by your hands or by putting the liner into a cleaning cover. After cleaning, dry the liner with a clean soft fabric, and then posit the liner on the cool place.
3. The liner must be assembled in the right position. Then you should buckle up the buttons.
4. Don't pull or drag violently when you dismantle or assemble visor and liner.
5. Liners come in different sizes. You could purchase or change the helmet after confirming sizes.