

x2

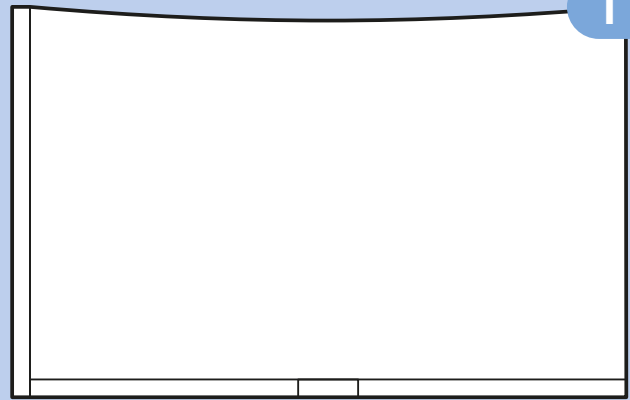

x4

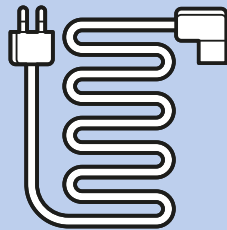
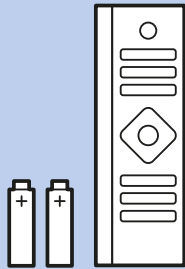

x4

Register your product and get support at  
[www.philips.com/welcome](http://www.philips.com/welcome)

8900 series  
55PUS8909C



# PHILIPS



English	Read the safety instructions.
Български	Прочетете инструкциите за безопасност.
Čeština	Přečtěte si bezpečnostní pokyny.
Hrvatski	Pročitajte sigurnosne upute.
Dansk	Læs sikkerhedsforskrifterne.
Deutsch	Lesen Sie die Sicherheitshinweise.
Ελληνικά	Διαβάστε τις οδηγίες ασφαλείας.
Eesti	Lugege ohutusnõudeid.
Español	Lea las instrucciones de seguridad.
Français	Lisez les consignes de sécurité.
Italiano	Leggere le istruzioni di sicurezza.
Қазақша	Қорғаныстық нұсқаулар.
Latviešu	Izlasiet drošības norādījumus.
Lietuvių	Perskaitykite saugos instrukcijas.
Magyar	Olvassa el a biztonsági utasításokat.
Nederlands	Lees de veiligheidsvoorschriften.
Norsk	Les sikkerhetsforskriftene.
Polski	Zapoznaj się z instrukcjami bezpieczeństwa.
Português	Leia as instruções de segurança.
Română	Citiți instrucțiunile de siguranță.
Русский	Читайте инструкции по технике безопасности.
Srpski	Pročitajte bezbednosna uputstva.
Slovenščina	Preberite varnostna navodila.
Slovenský	Prečítajte si bezpečnostné pokyny.
Suomi	Lue turvaohjeet.
Svenska	Läs säkerhetsinstruktionerna.
ภาษาไทย	โปรดอ่านคำแนะนำด้านความปลอดภัย
Türkçe	Güvenlik talimatlarını okuyun.
Українська	Читайте інструкції з техніки безпеки.

العربية قراءة تعليمات السلامة.  
עברית קראו את הוראות הבטיחות

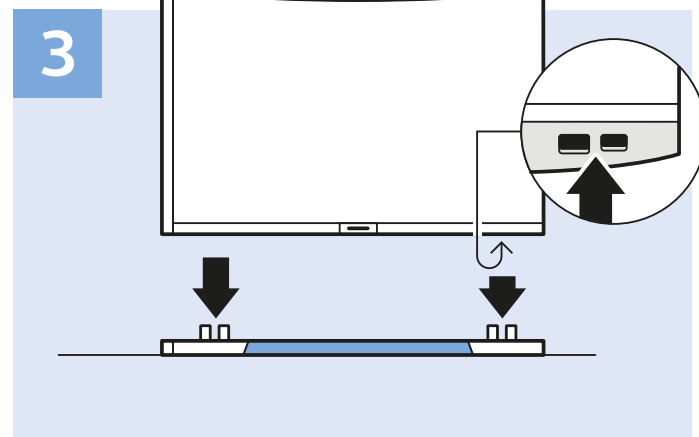
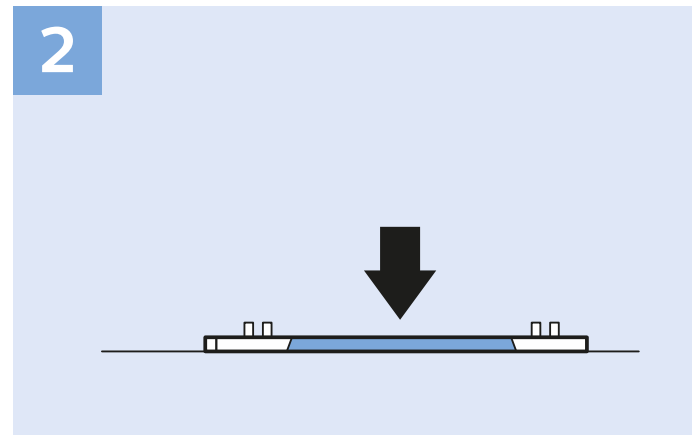
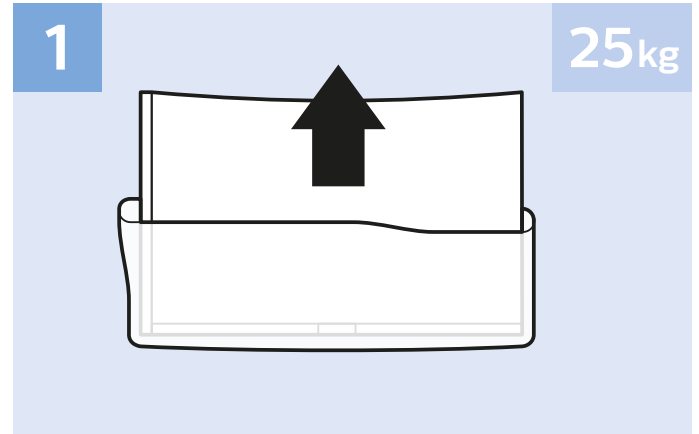

4

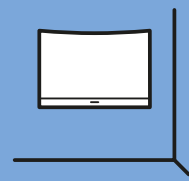
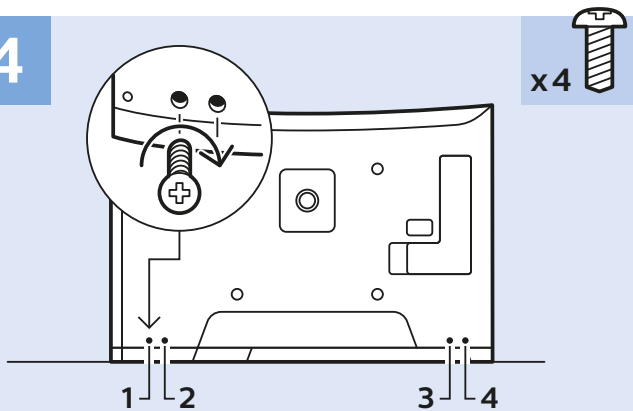

VESA 400x400 M6

5

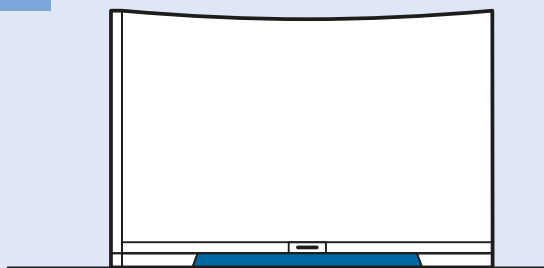

x4

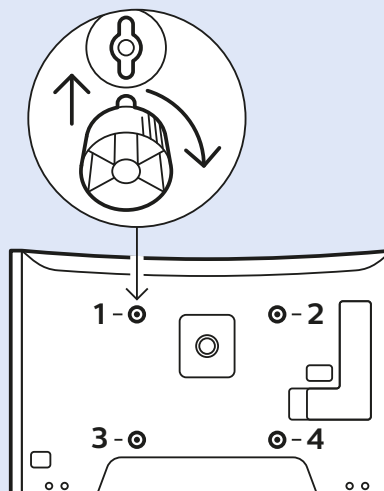

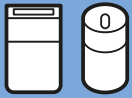

[www.philips.com/connectivityguide](http://www.philips.com/connectivityguide)

### POWER

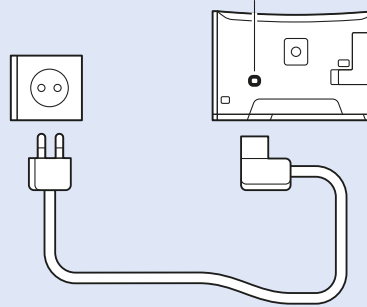

### ANTENNA

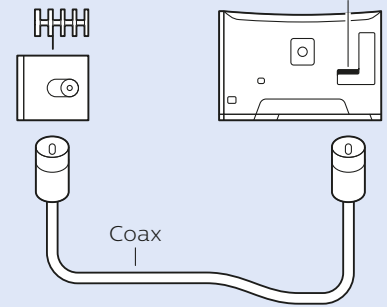

### SAT 1

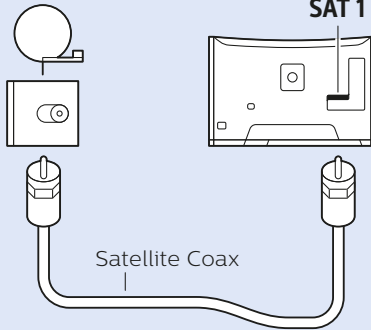

### COMMON INTERFACE 1

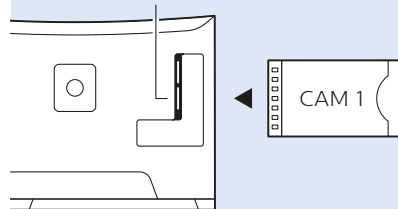

### COMMON INTERFACE 2

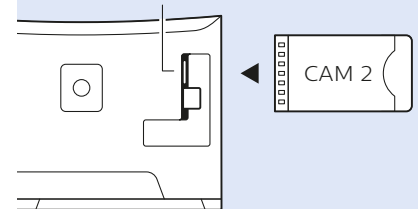

### Home Theatre System - UHD

#### HDMI 1

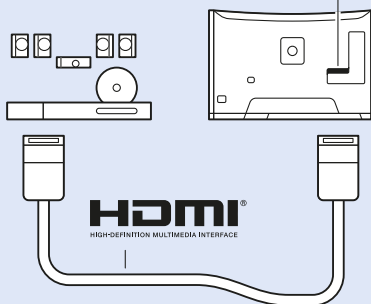

### Home Theatre System

#### HDMI + ARC

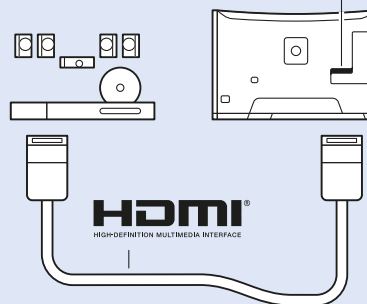

### Home Theatre System

#### AUDIO OUT - OPTICAL

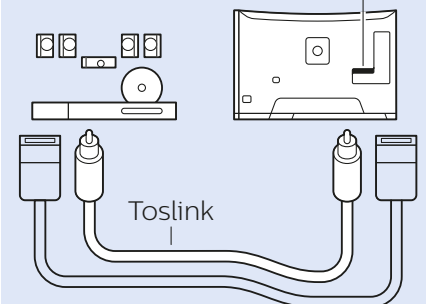

### USB Hard Drive

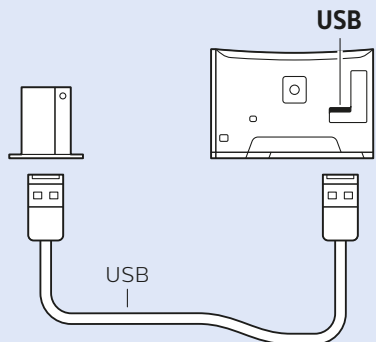

### Network - Wireless

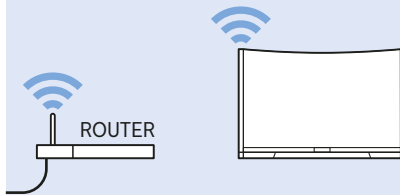

### Network - Wired

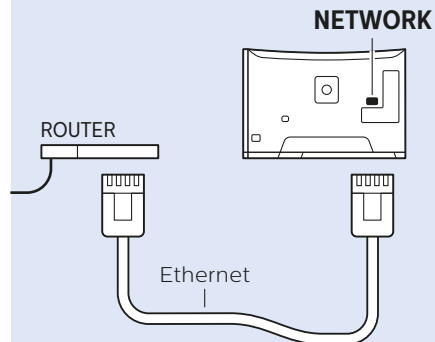

### Headphones

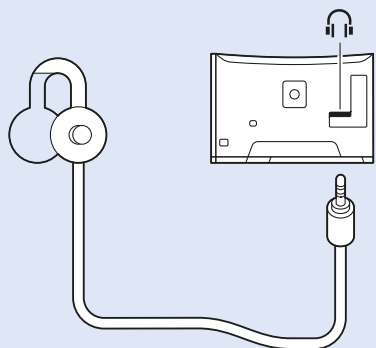

### Computer

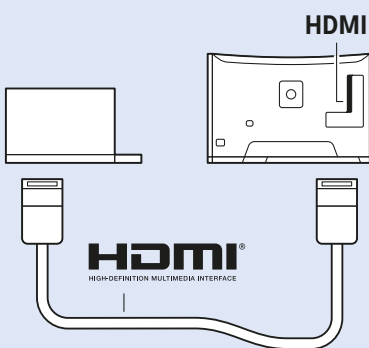

### Wireless Gamepad

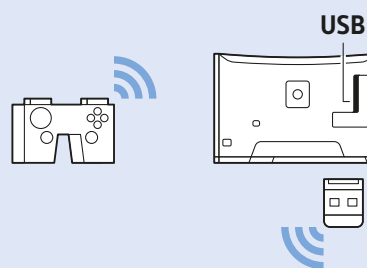

### Photo Camera

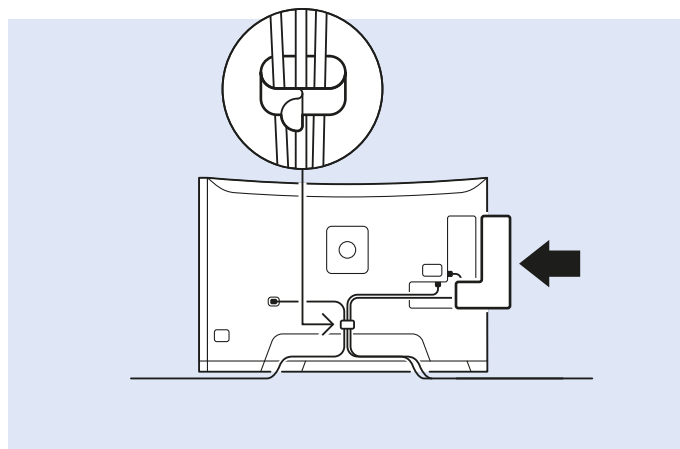
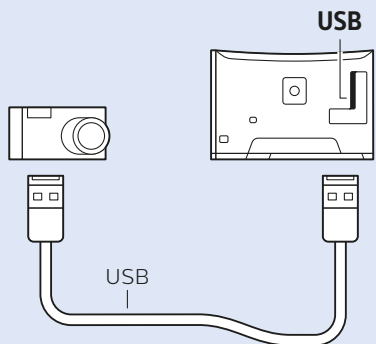

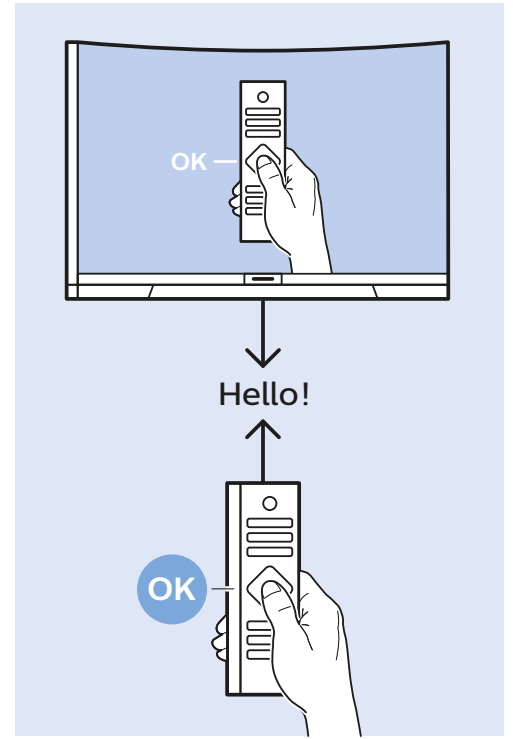
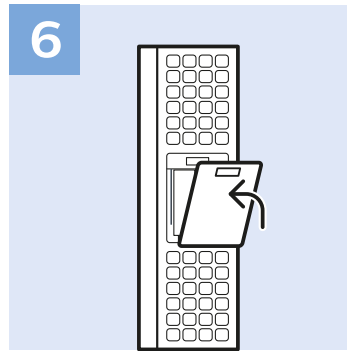
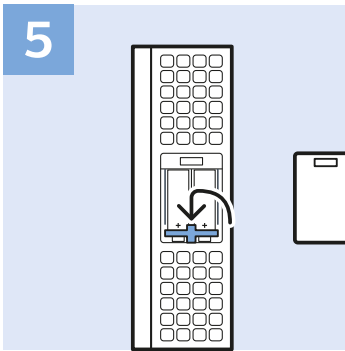
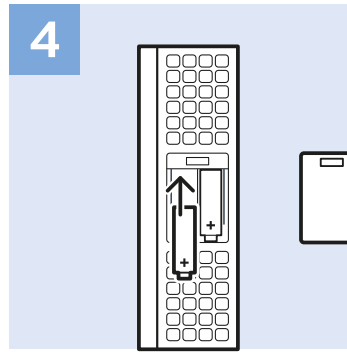
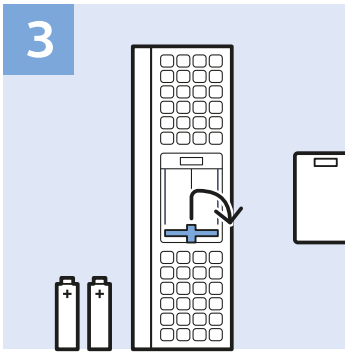
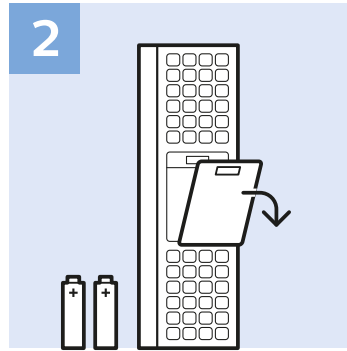
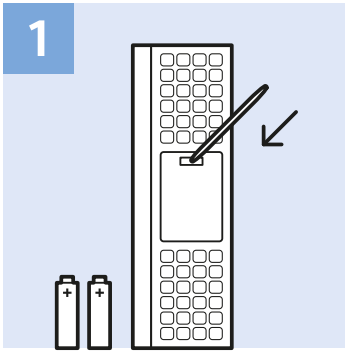

Bonjour!  
Привет!

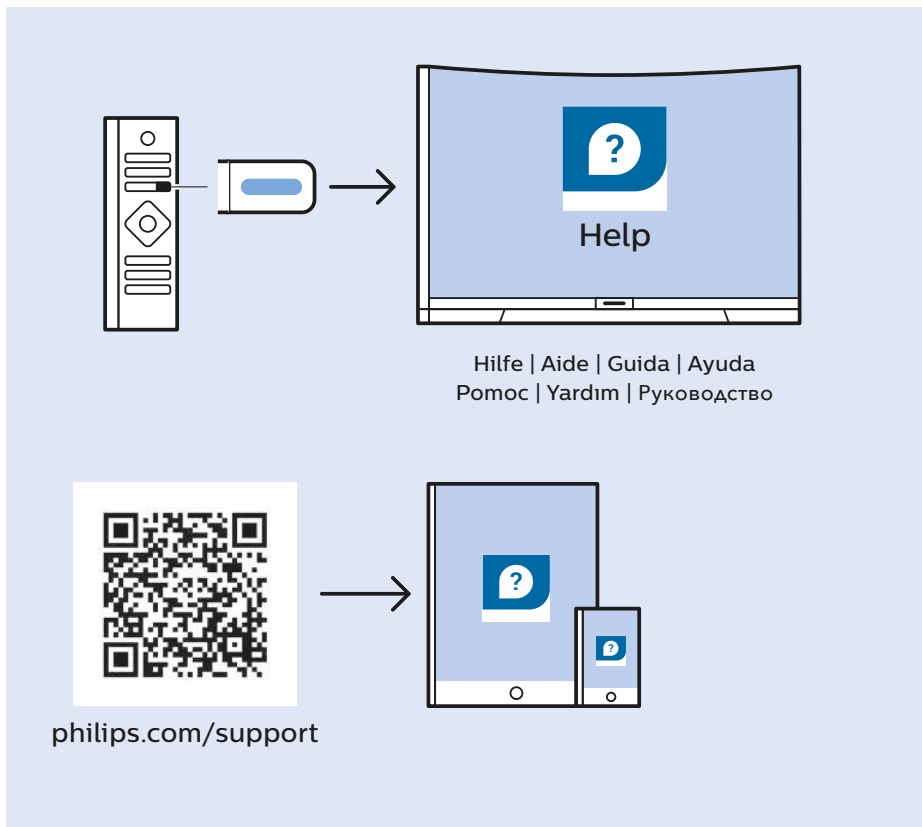
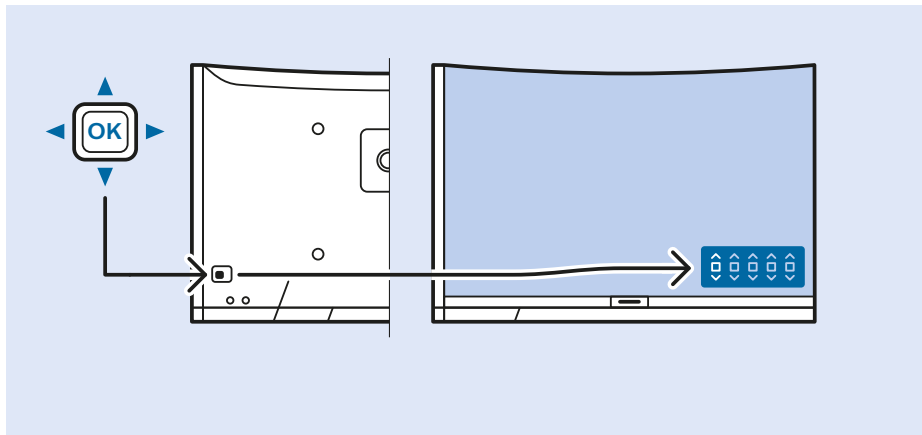

[User Manual](#)[FAQ](#)[Chat](#)[Forum](#)[Call](#)[Email](#)[Warranty](#)[www.philips.com/support](http://www.philips.com/support)**България**

Грижа за клиента  
**02 4916 273**  
 (Национален номер)

**België/Belgique**

Klantenservice/  
 Service Consommateurs  
**02 700 72 62**  
 (0.15€/min.)

**Bosna i Hercegovina**

Potpora potrošačima  
**033 941 251**  
 (Lokalni poziv)

**Republika Srbija**

Potpora potrošačima  
**011 321 6840**  
 (Lokalni poziv)

**Česká republika**

Zákaznická podpora  
**228 880 895**  
 (Místní tarif)

**Danmark**

Kundeservice  
**3525 8314**

**Deutschland**

Kundendienst  
**069 66 80 10 10**  
 (Zum Festnetztarif ihres  
 Anbieters)

**Ελλάδα**

Τμήμα καταναλωτών  
**2111983028**  
 (Διεθνής κλήση)

**Eesti**

Klienditugi  
**668 30 61**  
 (Kohalikud kõned)

**España**

Atención al consumidor  
**913 496 582**  
 (0,10€ + 0,08€/min.)

**France**

Service Consommateurs  
**01 57 32 40 50**  
 (coût d'un appel local sauf  
 surcoût éventuel selon  
 opérateur réseau)

**Hrvatska**

Potpora potrošačima  
**01 777 66 01**  
 (Lokalni poziv)

**Ireland**

Consumer Care  
**0150 284 21 40**  
 (National Call)

**Italia**

Servizio Consumatori  
**02 452 870 14**  
 (Chiamata nazionale)

**Қазақстан**

**Республикасы**  
 байланыс орталығы  
**810 800 2000 00 04**  
 (стационарлық нөмірлерден  
 Қазақстан Республикасы  
 бойынша қонырау шалу тегін)

**Latvija**

Klientu atbalsts  
**6616 32 63**  
 (Vietēlais tarifs)

**Lietuva**

Klientų palaikymo  
 tarnyba  
**8 521 402 93**  
 (Vietiniai tarifais)

**Luxembourg**

Service Consommateurs  
**2487 11 00**  
 (Appel national)/(Nationale  
 Ruf)

**Magyarország**

Ügyfélszolgálat  
**(061) 700 81 51**  
 (Belföldi hívás)

**Nederland**

Klantenservice  
**0900 202 08 71**  
 (0,10€/min.)

**Norge**

Forbrukerstotte  
**22 97 19 14**

**Österreich**

Kundendienst  
**0150 284 21 40**  
 (0,145€/Min.)

**Республика Беларусь**

Контакт Центр  
**8 10 (800) 2000 00 04**  
 (бесплатный звонок по  
 Республике Беларусь со  
 стационарных номеров)

**Российская Федерация**

Контакт Центр  
**8 (800) 220 00 04**  
 (бесплатный звонок по  
 России)

**Polska**

Wsparcie Klienta  
**22 397 15 04**  
 (Połączenie lokalne)

**Portugal**

Assistência a clientes  
**800 780 068**  
 (0,12€/min. – Móvel 0,30€/min.)

**România**

Serviciul Clienti  
**031 630 00 42**  
 (Tarif local)

**Schweiz/Suisse/**

**Svizzera**  
 Kundendienst/Service  
 Consommateurs/Servizio  
 Consumatori  
**0848 000 291**  
 (0,081 CHF/Min)

**Slovenija**

Skrb za potrošnike  
**01 88 88 312**  
 (Lokalni klic)

**Slovensko**

Zákaznická podpora  
**02 332 154 93**  
 (vnútroštátny hovor)

**Suomi**

Finland Kuluttajapalvelu  
**09 88 62 50 40**

**Sverige**

Kundtjänst  
**08 57 92 90 96**

**Türkiye**

Tüketici Hizmetleri  
**0 850 222 44 66**

**Україна**

Служба підтримки  
 споживачів  
**0-800-500-480**  
 (дзвінки зі  
 стаціонарних телефонів  
 безкоштовні)

**United Kingdom**

Consumer Care  
**020 79 49 03 19**  
 (5p/min BT landline)

**Argentina**

Consumer Care  
**0800 444 77 49**  
 – Buenos Aires  
**0810 44 7782**

**Brasil**

Suporte ao Consumidor  
**0800 701 02 45**  
 – São Paulo  
**29 38 02 45**



All registered and unregistered trademarks are property of their respective owners. Specifications are subject to change without notice. Philips and the Philips' shield emblem are trademarks of Koninklijke Philips N.V. and are used under license from Koninklijke Philips N.V. 2014 © TP Vision Europe B.V. All rights reserved. philips.com