



Philips Consumer Lifestyle

Version: A

Service Manual

PRODUCT INFORMATION

- This product meets the requirements regarding interference suppression on radio and TV.
- After the product has been repaired, it should function properly and has to meet the safety requirements as officially laid down at this moment.

Perfect end results at the touch of a button

- Easy press down operation
- Powerful 450 W motor

Effortlessly easy

- Dishwasher safe

Reliably durable

- Large 0.7 L bowl
- Stainless steel blade that stays sharp

Dimensions:

Diameter: 120 mm

Height with Power unit: 210 mm

Weight: 960 g

DISASSEMBLY- AND RE-ASSEMBLY ADVISE

- No specific issues.

REPAIR INSTRUCTION

- No specific issues.

OPTIONAL (accessories)

- No specific issues.

Technical specifications

- Cleaning: All accessories dishwashersafe
- Capacity chopper: 0.7 l
- Frequency: 50/60 Hz
- Power: 450 W
- Usable volume chopper: 0.5 l
- Voltage: 220-240 V

Design

- Color(s): White
- Material bowl: Plastic
- Material housing: Plastic ABS
- Material knives: Stainless steel



Implemented since yyww 1504

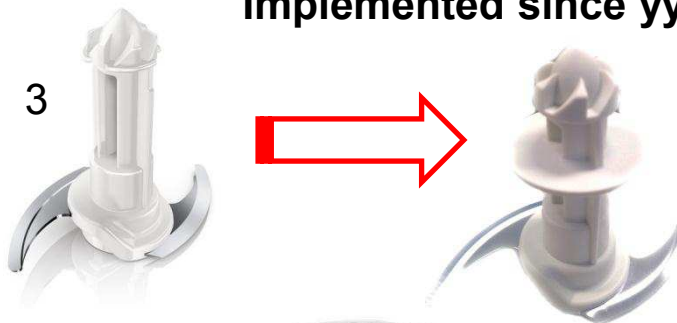

Pos	12 NC	Description
1	4203 036 01441	Powerunit complete EU (HV)
	4203 036 01451	Powerunit complete UK, DB - (HR1393/01)
2	4203 036 01461	Lid
3	4203 036 01471	Blade unit
4	4203 036 01481	Chopper Bowl

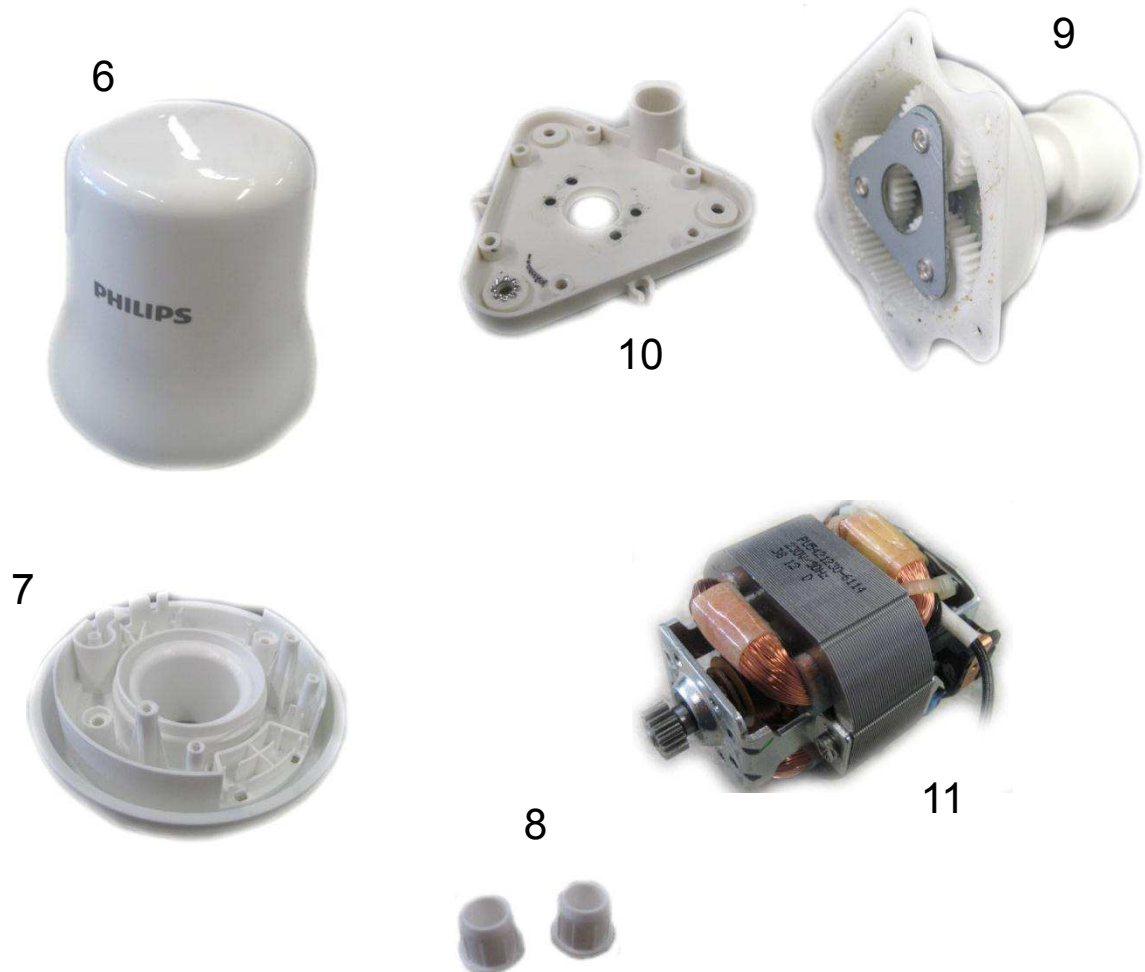

Pos	12 NC	Description
5	4203 036 01691	Cordset 2 pin (HR1393/00)
	4203 036 01701	Cordset 3 pin (HR1393/01)
6	4203 036 01711	Housing
7	4203 036 01721	Bottom
8	4203 036 01731	Cover plug (2x)
9	4203 036 01741	Gearing + coupling
10	4203 036 01751	Gearing housing
11	4203 036 01761	Motor (HV)