



# SIDELOCK

## 3. Adjustment

**Specific information**  
part of instructions for use

### DARTWIN SIDELOCK

- (EN) Crampons
- (FR) Crampons
- (DE) Steigeisen
- (IT) Ramponi
- (ES) Crampones

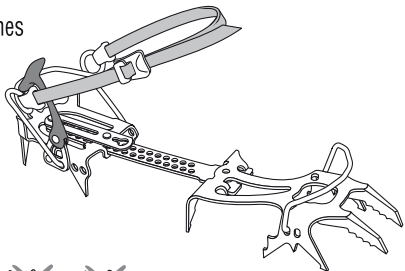

EN 893

UIAA

2 x 430 g = 860 g

x 12

With reversible linking bars Medium < 10.1/3 (US)  
Avec barrettes reversibles Medium < 44 (FR)

3 year guarantee

T21SL02



price

T21500-F (140407) Recto

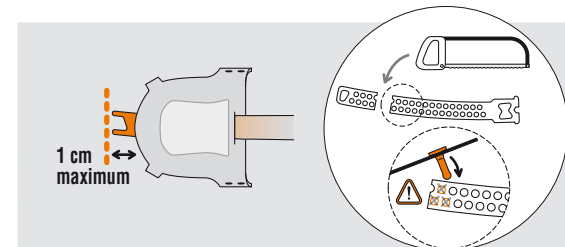
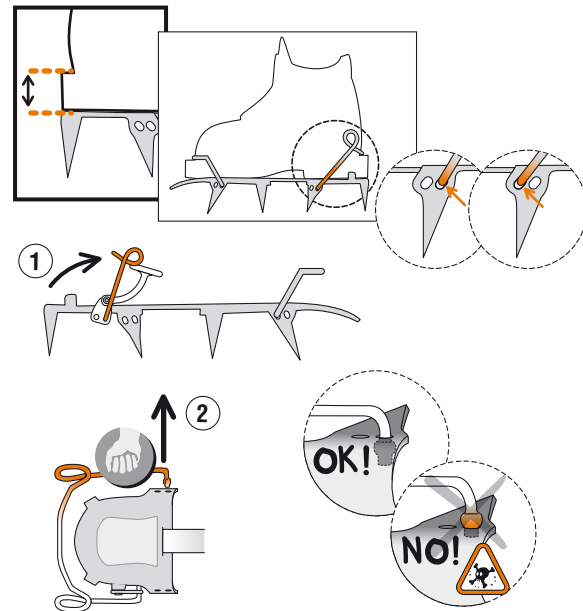
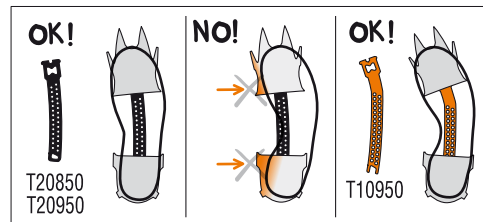
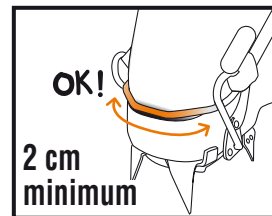
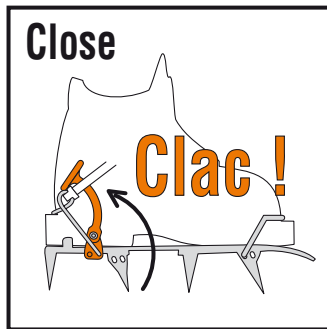
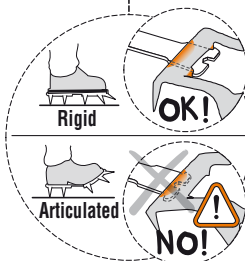
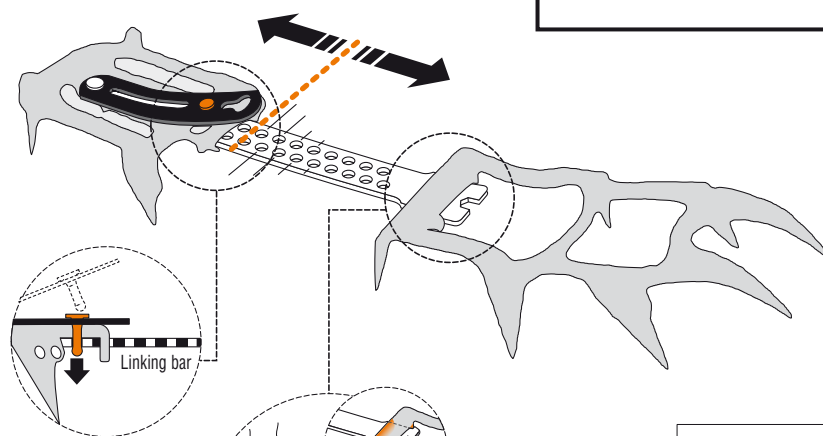
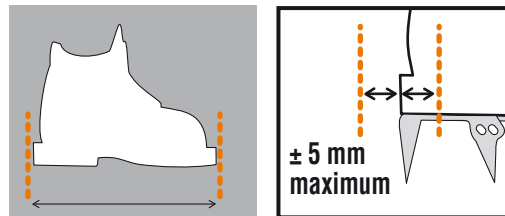
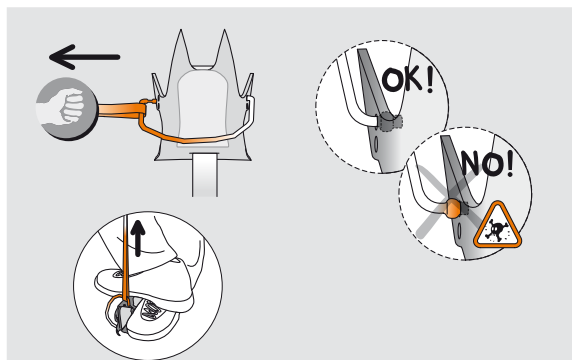
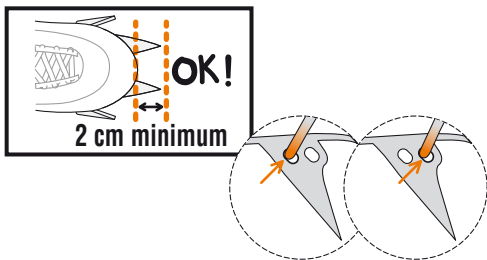
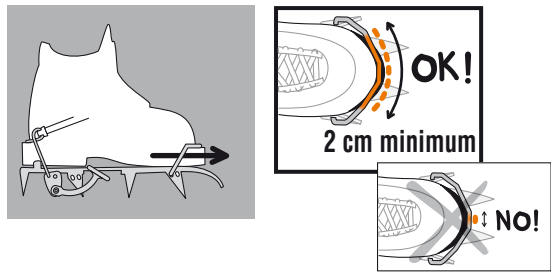

# SIDELOCK

## 4. Attachment to the boots

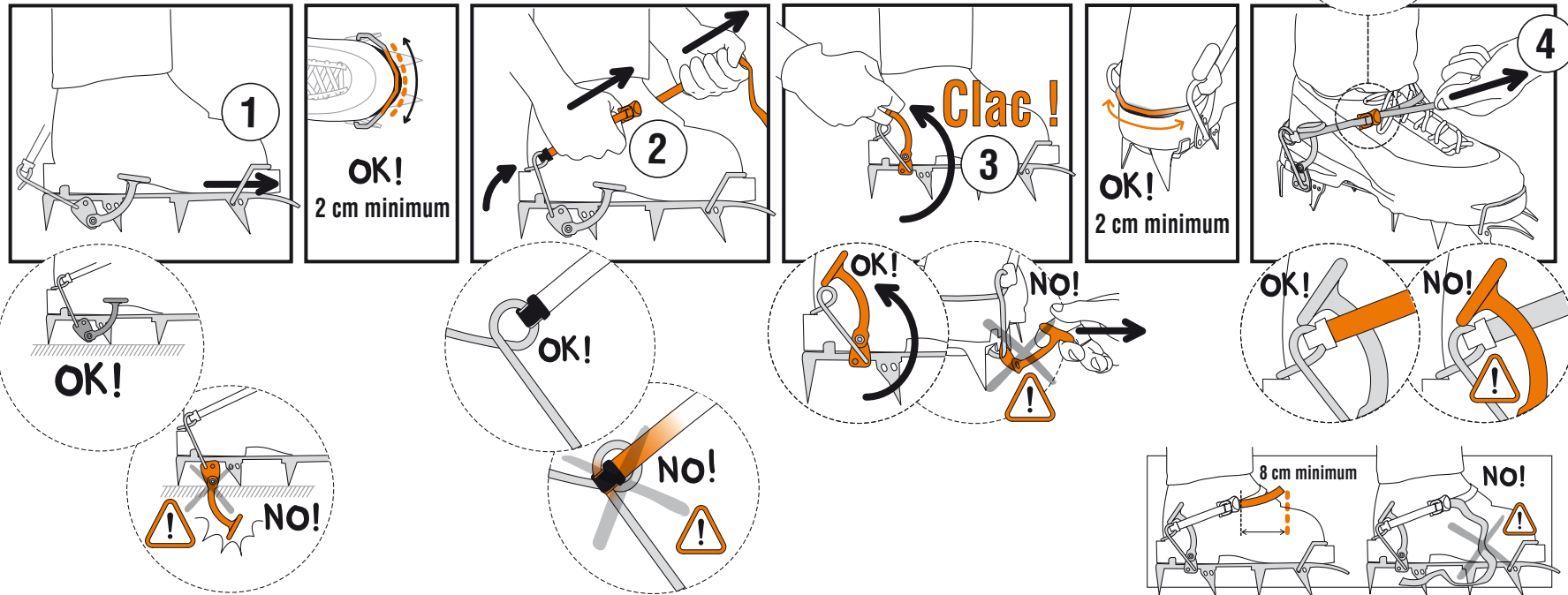
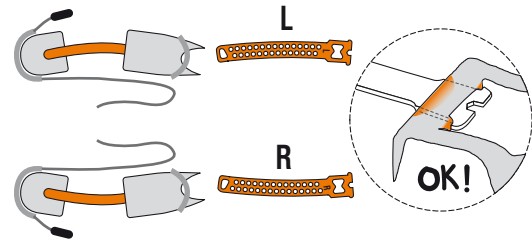

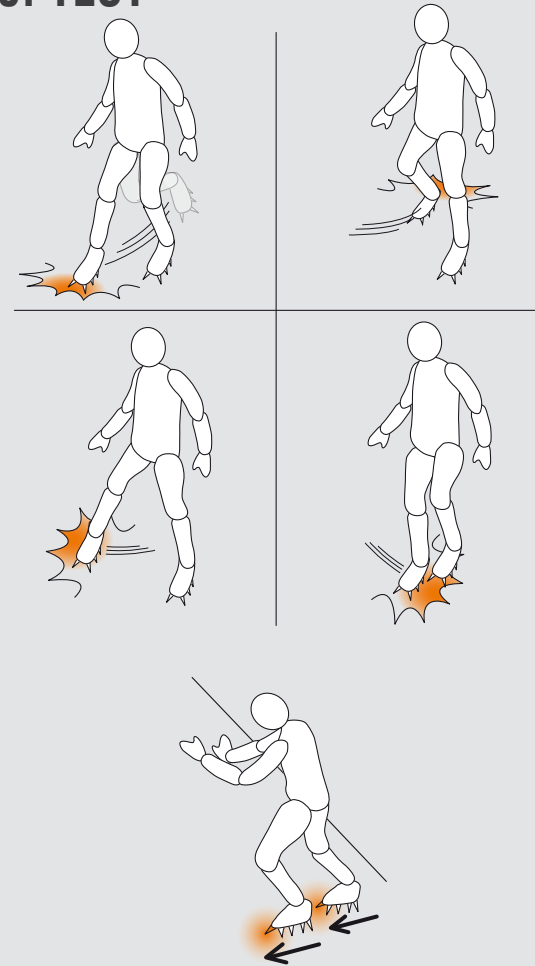

## 5. TEST





## Spare parts / Pièces détachées : DARTWIN SIDELOCK T21SL02

**2 reversible linking bars L**  
2 barrettes reversibles L T20850

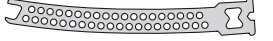
5,1/3 <  < 14,1/3 (US)
38 <  < 49 (FR)



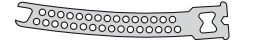

**2 reversible linking bars M**  
2 barrettes reversibles M T20950

2,1/3 <  < 10,1/3 (US)
34 <  < 44 (FR)



**2 curved linking bars L for asymmetrical boots**  
2 barrettes incurvées L pour chaussures asymétriques T10950

7,3/4 <  < 14,2/3 (US)
42 <  < 50 (FR)

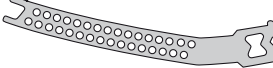

**2 spurs**  
2 épérons T21850 02

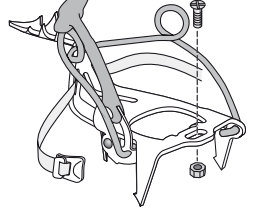

**SIDELOCK strap kit**  
Kit lanières SIDELOCK T10850

**2 fronts bars DART**  
2 avants DART T20800

**2 toebail safety straps**  
2 pattes de sécurité fil avant T10800



**Telemark front wires**  
Fils avants télémarque T03600

