



Instructions for use

ART 200

Whirlpool Switzerland, www.whirlpool.ch

Bauknecht AG, Industriestrasse 36, 5600 Lenzburg, www.bauknecht.ch

Verkauf	Telefon 0848 801 002	Fax 0848 801 017	verkauf@bauknecht.ch
Kundendienst	Telefon 0848 801 001	Fax 0848 801 003	service@bauknecht.ch
Ersatzteile	Telefon 0848 801 005	Fax 0848 801 004	ersatzteilverkauf@bauknecht.ch

CONTENTS

GB

DESCRIPTION OF THE APPLIANCE

PAGE 10

REPLACING THE LIGHT BULB

PAGE 10

BEFORE USING THE REFRIGERATOR

PAGE 11

PROTECTING THE ENVIRONMENT

PAGE 11

**PRECAUTIONS AND GENERAL
RECOMMENDATIONS**

PAGE 11

**HOW TO USE THE REFRIGERATOR
COMPARTMENT**

PAGE 12

HOW TO DEFROST THE APPLIANCE

PAGE 13

CARE AND MAINTENANCE

PAGE 13

TROUBLESHOOTING GUIDE

PAGE 14

AFTER-SALES SERVICE

PAGE 14

INSTALLATION

PAGE 14

ELECTRICAL CONNECTION

PAGE 15

DESCRIPTION OF THE APPLIANCE

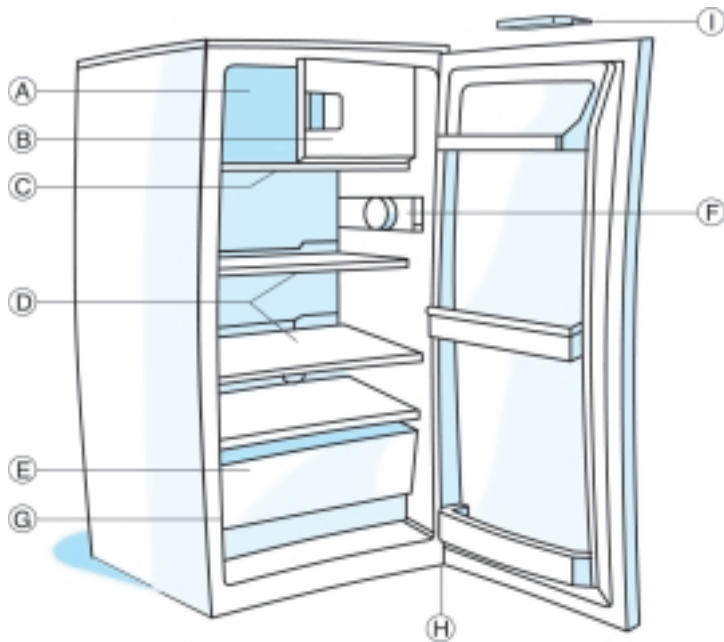

- A Low temperature compartment
- B Low temperature compartment door
- C Water collecting tray
- D Adjustable grid shelves
- E Crisper drawer
- F Temperature adjustment thermostat
- G Rating plate (at the side of crisper drawer)
- H Adjustable foot
- I Door seal spacers for transport purposes (remove and discard)

REPLACING THE LIGHT BULB

Replacing the light bulb

1. Push as shown in the picture.
2. Pull towards the inside of the refrigerator.
3. Replace the light bulb (Max 15W).

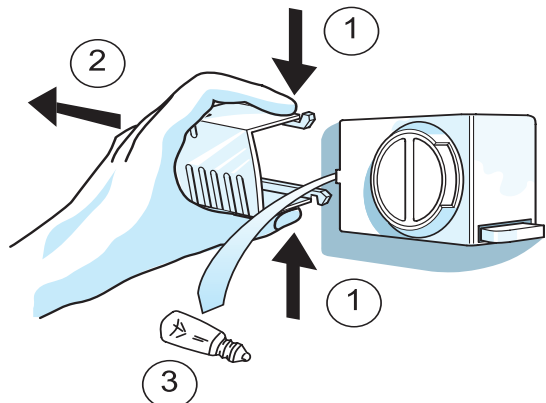

BEFORE USING THE REFRIGERATOR

- Your new appliance is exclusively for domestic use.
- The **low temperature compartment** can be used to make ice cubes.
- **Defrosting is a manual or semiautomatic procedure.** The **refrigerator compartment** is used for the storage of fresh food and beverages.
- To get the most out of your new appliance, please read the user handbook thoroughly. The handbook contains a description of the appliance and useful tips for storing food.
- Keep this handbook for future consultation.
- Discard the door seal spacer shown at point I of the figure.
- After unpacking the appliance, make sure that the door shuts properly. Any damage must be reported to your dealer within 24 hours after delivery of the appliance.
- **Wait at least two hours before connecting the appliance to the power supply in order to ensure the refrigerant circuit is fully efficient.**
- Appliance installation and electrical connections must be carried out by a qualified electrician, in accordance with the manufacturer's instructions and local regulations.

PROTECTING THE ENVIRONMENT

1. Packaging

The packaging material is entirely recyclable, and is marked with the recycling symbol.

Follow local regulations for scrapping.

Packaging material (plastic bags, polystyrene padding, polythene film, etc.) must be kept out of the reach of children as it constitutes a potential risk.

2. Appliance

The appliance is made from recyclable materials. Dispose of the appliance in conformity with local environmental regulations.

Make the appliance unusable by cutting off the power cord. The appliance must be consigned to an authorised collection centre for the recovery of refrigerant gas.

Information:

This appliance does not contain CFCs (replaced with R134a) or HFCs (replaced with

R600a - Isobutane). For more information, refer to the rating plate affixed to the appliance.

Appliances with isobutane (R600a)

Isobutane is a naturally occurring low environmental impact gas. Caution is required, however, because Isobutane is inflammable. Therefore, it is essential to ensure that refrigerant pipelines are not damaged.

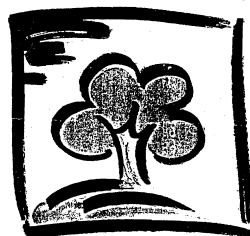

PRECAUTIONS AND GENERAL RECOMMENDATIONS

- Use **the refrigerator compartment** only for storing fresh foods and the **low temperature compartment** only for making ice cubes.
- Do not cover or obstruct the air vents of the appliance.
- Do not store liquids in glass containers in the low temperature compartment - danger of bursting.
- Do not eat ice cubes or ice lollies immediately after taking them out of the low temperature compartment - risk of frost burns.
- Do not allow children to play or hide inside the appliance - risk of becoming entrapped and suffocating.
- Before servicing or cleaning the appliance, unplug it from the mains or disconnect the electricity supply.
- The power cable can only be replaced by an authorised person.

Declaration of conformity

This appliance is intended to come into contact with foodstuffs and conforms to D.L. 108 of 25.01.1992 (European Directive 89/109/EEC).

HOW TO USE THE REFRIGERATOR COMPARTMENT

Starting the appliance

Switching on the appliance

- Plug in the appliance.
- The inside light, if present, switches on when the refrigerator door is opened.

Temperature adjustment

Make sure the water-collecting tray, located under the low temperature compartment, is pushed fully against the rear wall of the refrigerator.

The thermostat, fitted at the right-hand side of the refrigerator compartment, controls the inside temperature.

To alter the temperature in the refrigerator compartment set the thermostat knob to:

- lower numbers **1-2** if you require **HIGHER** temperatures;
- numbers **2,5** for a **MEDIUM** temperature
- higher numbers **4-5** for **LOWER** temperatures.

Thermostat setting on ● or ✱ : all functions of the appliance are switched off, but the appliance is not disconnected from the power supply.

Note:

Internal temperatures are affected by room temperature, frequency of door opening and the position of the appliance. These factors must be taken into account when setting the thermostat.

Adjusting the position of the water collecting tray:

when the room temperature is 25°C or above, it is advisable to pull the water-collecting tray towards the refrigerator's door, aligning it with the two small dots on the right-hand side of the low temperature compartment (Fig. 1).

Using the refrigerator compartment

Position the food as follows:

- A **Cooked food, cakes, soups:** on the grid immediately under the low temperature compartment
- B **Fish, meat, cold cuts:** on the grid immediately above the crisper drawer
- C **Fruit and vegetables:** use the crisper drawer
- D **Bottles, packaged food:** use the door trays on the inner door
- E **Eggs:** use the specially made compartment on the inner door

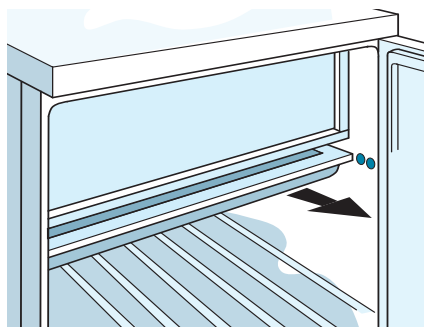
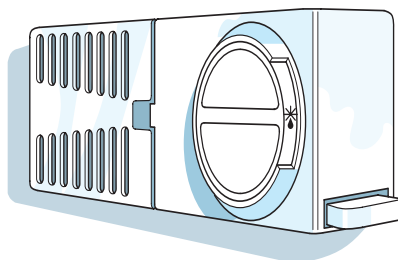

(Fig. 1)

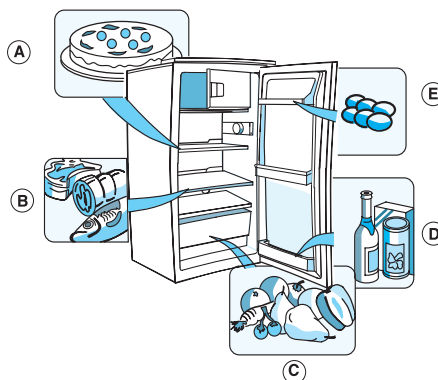

Notes:

- The space between the shelves and the rear wall of the refrigerator compartment must be unobstructed to allow air circulation.
- Do not place food in direct contact with the rear wall of the refrigerator compartment.
- Do not place hot food in the refrigerator.
- Store liquids in closed containers.

HOW TO DEFROST THE APPLIANCE

Defrost the appliance when the ice formation on the walls reaches 3 mm.

Make sure that the water-collecting tray is empty and properly positioned under the low temperature compartment.

Semiautomatic defrosting (Fig. 1)

- Push the button (A) in the center of the thermostat knob and close the door. When the ice on the walls has melted completely, the button will return to its initial position and the appliance will restart automatically.

Manual defrosting (Fig. 2)

Appliances without defrosting button:

- Turn the thermostat knob to the defrosting position.
- When defrosting is complete, turn the knob back to its initial position.

It is not necessary to empty the rest of the appliance.

Do not use sharp or pointed metal instruments to scrape off ice.

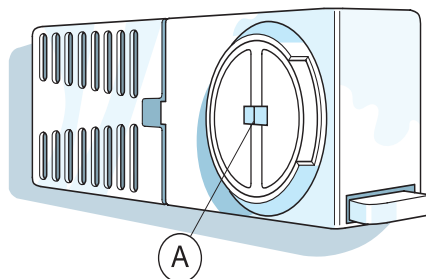

(Fig. 1)

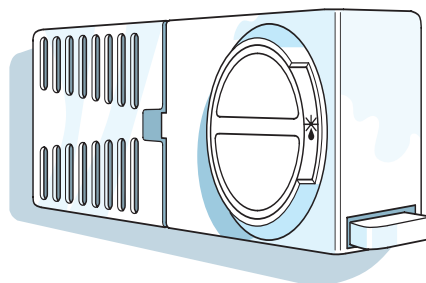

(Fig. 2)

CARE AND MAINTENANCE

Before any cleaning or maintenance operation, unplug the appliance from the mains or disconnect the electrical power supply.

- Clean the interior regularly with a sponge soaked in warm water and/or neutral detergent. Do not use abrasive products.
- Rinse the interior and dry thoroughly.
- Clean the inside of the low temperature compartment when defrosting.
- Clean the outside with a damp cloth. Do not use abrasive products, scourers, stain-removers (e.g. acetone, trichloroethylene) nor vinegar.
- Regularly clean air vents and the condenser at the rear of the appliance with a vacuum cleaner or a brush.

Prolonged disuse

1. Empty the refrigerator.
2. Unplug the appliance.
3. Defrost and clean the interior.

4. When not in use, leave the door of the appliance open to prevent oxidation and the formation of mould and unpleasant odours.
5. Clean the appliance.

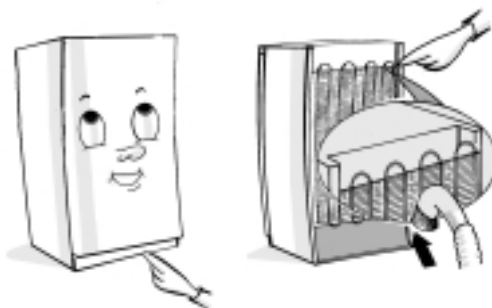

TROUBLESHOOTING GUIDE

- 1. The appliance is not working.**
 - No electrical power?
 - Is the power cord in perfect condition?
 - Is the plug properly inserted in the mains socket?
 - Has the fuse blown?
 - Is the thermostat knob on position ● (Stop) or ✱ (defrosting)?
 - 2. Temperature inside the compartments is not low enough.**
 - Is the door shut properly?
 - Is there excessive frost build-up in the low temperature compartment?
 - Is the appliance installed next to a heat source?
 - Is the thermostat setting correct?
 - Are the air circulation vents blocked?
 - 3. Temperature inside the refrigerator compartment is too low.**
 - Is the thermostat setting correct?
 - 4. The appliance is excessively noisy.**
 - Has the appliance been installed correctly?
 - Are the pipes at the back touching or vibrating?
 - 5. Water collects at bottom of refrigerator compartment.**
 - Is the thermostat setting correct?
 - 6. The inside light is not working**
 - No electrical power?
 - If electrical power is present, unplug the appliance, remove the cover and check that the light bulb is properly screwed-in. If necessary, replace the bulb (max 15 W).
- Notes:**
- **Gurgling and hissing noises due to expansion in the refrigerant circuit are normal.**

AFTER-SALES SERVICE

Before contacting After-Sales Service:

1. See if you can solve the problem yourself with the help of the Trouble-shooting guide.
2. Switch the appliance on again to see if the problem has been solved. If it has not, disconnect the appliance from the power supply and wait for about an hour before switching on again.
3. If the problem persists after this course of action, contact After-Sales Service.
Specify:

- the nature of the problem
- the model
- the Service number (the number after the word SERVICE on the rating plate on the inside of the appliance)

SERVICE 0000 000 00000



- your full address
- your telephone number and area code.



INSTALLATION

- Situate the appliance away from heat sources. Positioning the appliance in a hot environment, direct exposure to the sun or proximity to heat sources (heaters, radiators, cookers) will increase power consumption and should therefore be avoided.
- leave at least a 5 cm gap above the appliance and make sure that adjacent kitchen units are sufficiently distanced to allow air circulation.
- Position the refrigerator in a dry, well-ventilated place. Make sure it is level, adjusting the front feet if necessary.
- Make sure that the air vent at the top of the appliance is unblocked, to allow air circulation.
- Clean the inside of the appliance and fit the supplied accessories.
- Fill the ice cube tray (if supplied) with water and put it into the low temperature compartment.

Electrical connection

- **Electrical connections must be made in accordance with local regulations.**
- Voltage and power consumption are indicated on the rating plate inside the appliance.
- **Regulations require that the appliance is earthed.**
The Manufacturer declines all liabilities for injury to persons or animals or damage to property resulting from failure to observe these regulations.
- If the plug and socket are not of the same type, have the socket replaced by a qualified electrician.
- Do not use extension leads or adapters.

ELECTRICAL CONNECTION

For Great Britain only

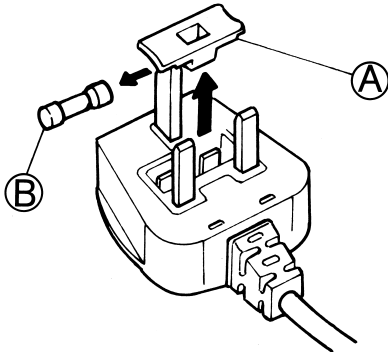

The wires in the mains lead are coloured in accordance with the following code:

BLUE - "NEUTRAL" ("N")

BROWN - "LIVE" ("L")

GREEN AND YELLOW - "EARTH" ("E")

1. The GREEN AND YELLOW wire must be connected to the terminal in the plug which is marked with the letter "E" or by the Earth symbol 4 or coloured green or green and yellow.
2. The BLUE wire must be connected to the terminal which is marked with the letter "N" or coloured black.
3. The BROWN wire must be connected to the terminal which is marked with the letter "L" or coloured red.

Warning - this appliance must be earthed

Fuse replacement

If the mains lead of this appliance is fitted with a BS 1363A 13amp fused plug, to change a fuse in this type of plug use an A.S.T.A. approved fuse to BS 1362 type and proceed as follows:

1. Remove the fuse cover (A) and fuse (B).
2. Fit replacement 13A fuse into fuse cover.
3. Refit both into plug.

Important:

The fuse cover must be refitted when changing a fuse and if the fuse cover is lost the plug must not be used until a correct replacement is fitted.

Correct replacement are identified by the colour insert or the colour embossed in words on the base of the plug.

Replacement fuse covers are available from your local electrical store.

Connection to a rewirable plug

If the fitted plug is not suitable for your socket outlet, then it should be cut off and disposed of in order to avoid a possible shock hazard should it be inserted into a 13A socket elsewhere.

A suitable alternative plug should then be fitted to the cable.

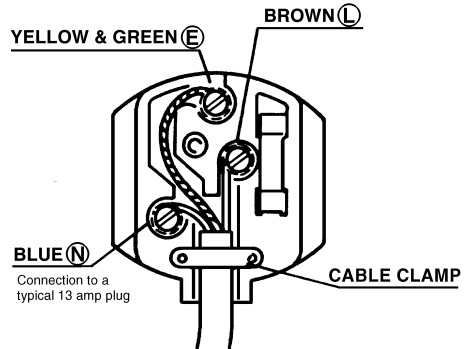

For the Republic of Ireland only

The information given in respect of Great Britain will frequently apply, but a third type of plug and socket is also used, the 2-pin, side earth type. In this case, the wire which is coloured GREEN AND YELLOW must be connected to the EARTH contact, and the two wires to the two pins, irrespective of colour. The supply to the socket must be fitted with a 16 amp fuse.