



WARNING!

TOY MUST BE ASSEMBLED BY AN ADULT BEFORE USE.

THIS PRODUCT CONTAINS SMALL PARTS AND IS NOT SUITABLE FOR CHILDREN UNDER 36 MONTHS. SMALL PARTS. CHOKING HAZARD.

THIS PRODUCT IS NOT SUITABLE FOR CHILDREN UNDER 36 MONTHS AS IT CONTAINS A LONG STRAP WHICH POSES A POTENTIAL ENTANGLEMENT HAZARD.

WARNING! ONLY FOR DOMESTIC USE. FOR OUTDOOR USE. ADULT SUPERVISION IS REQUIRED.

CHILDREN MUST NOT USE THE EQUIPMENT UNTIL PROPERLY INSTALLED.

REMOVE ALL PACKAGING BEFORE GIVING TO YOUR CHILDREN

WARNING: AGES 6 YEARS+..

TP575 Ground Stake Kit

INSTRUCTIONS FOR ASSEMBLY MAINTENANCE AND USE.

PLEASE RETAIN FOR FUTURE REFERENCE.



This Ground Stake Kit is designed to be used on any round trampoline. It has two basic purposes. For certain types of trampolines it will enable the owner to move the trampoline without the vertical leg pieces separating from the frame. It is also an anchor down system for all trampolines that are sited in locations exposed to high winds. Differing soil and weather conditions could influence the effectiveness of any installation using this kit. TP does not state, grant, or imply any guarantees as to performance or appropriateness of this tp anchor down kit, or any of its components, in any application whatsoever.

Make sure that there are no underground utilities (i.e. Electrical, gas, telephone, water or sprinkler) before installing the auger stakes. The installation of this kit should be performed by an adult.

Contents - Please check

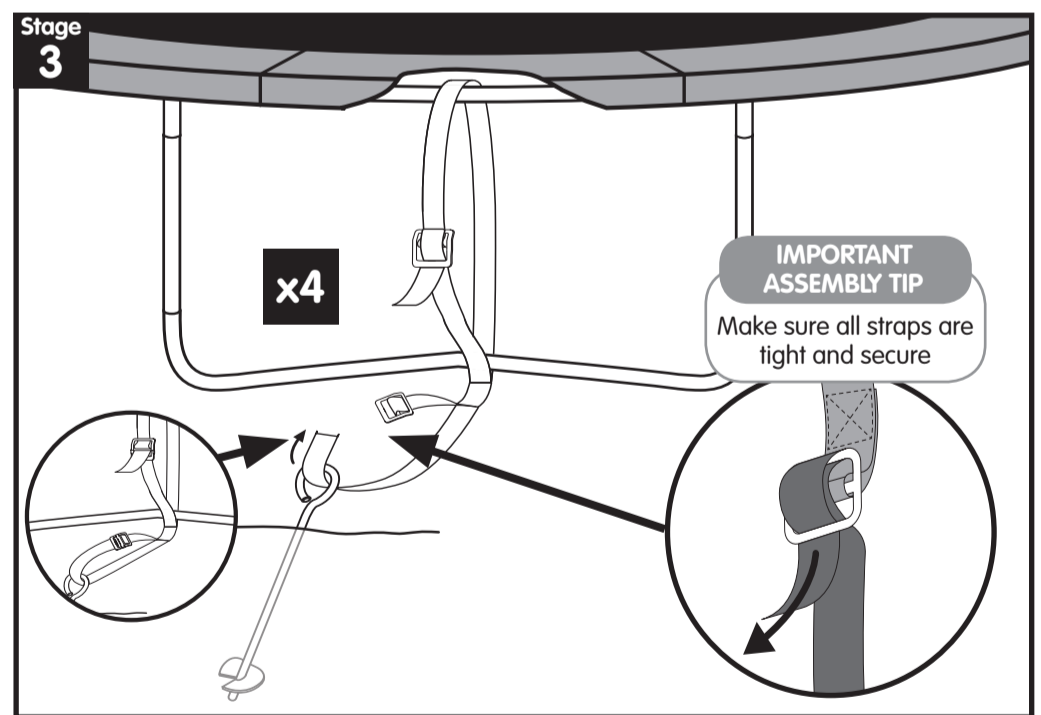
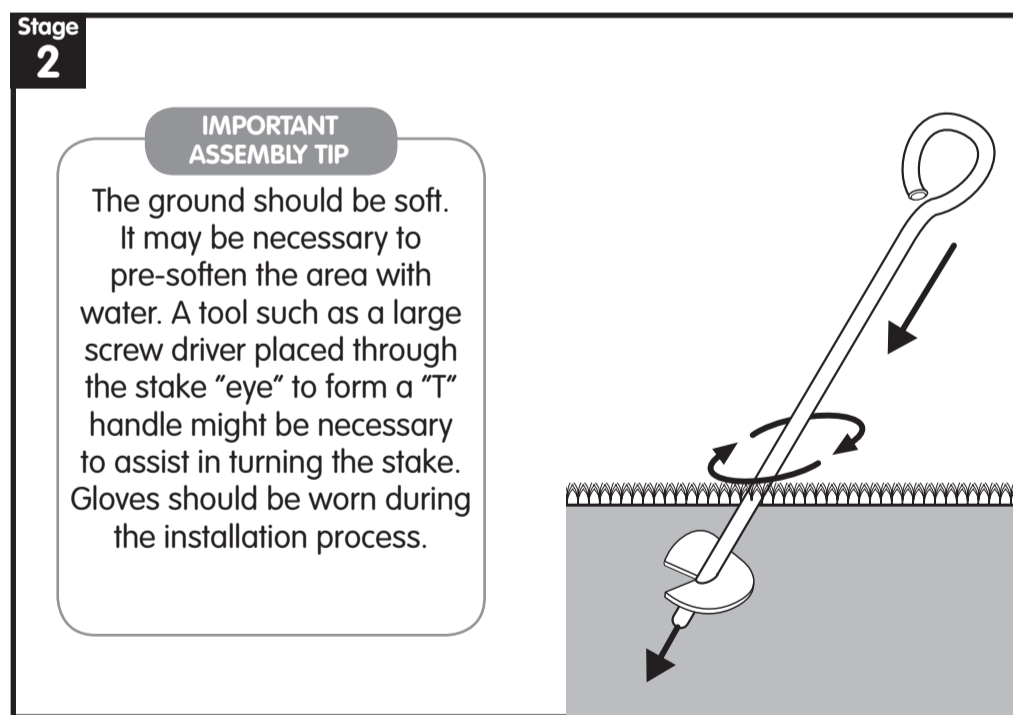
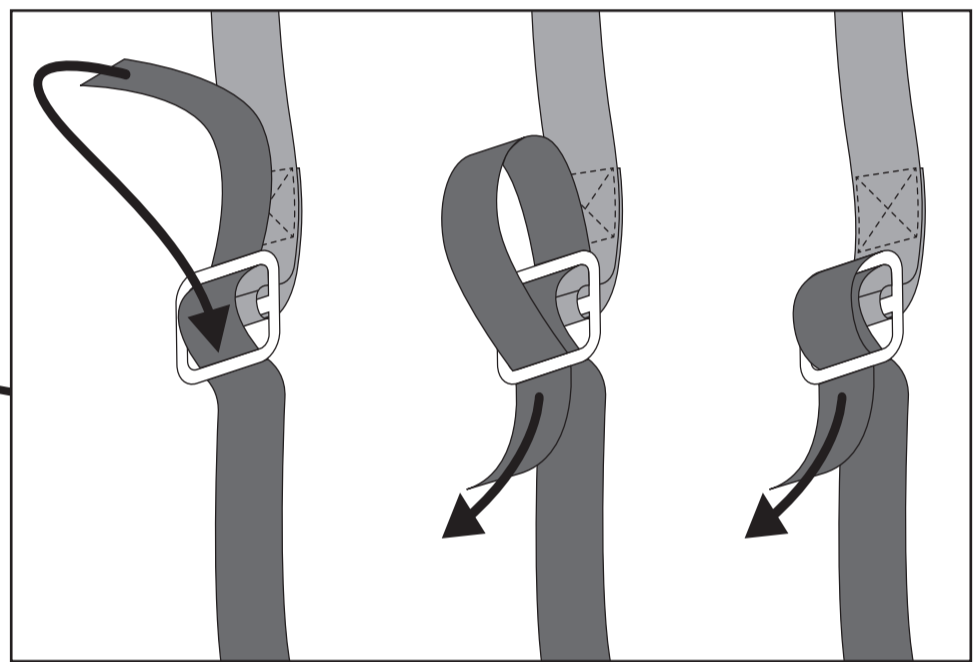
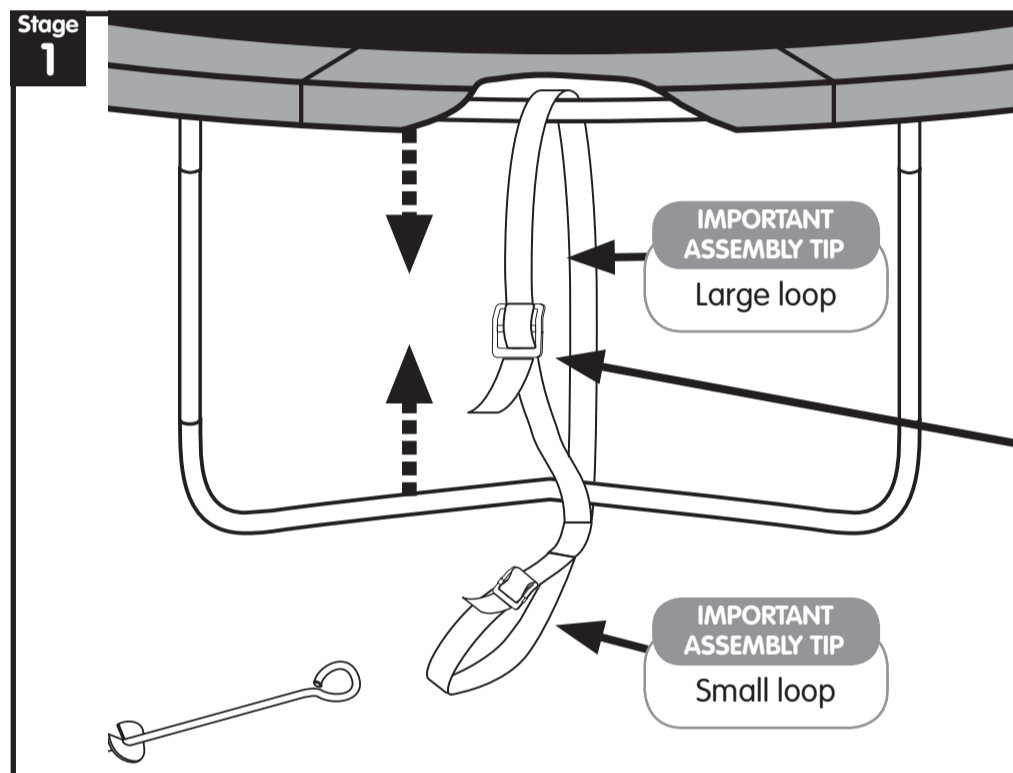
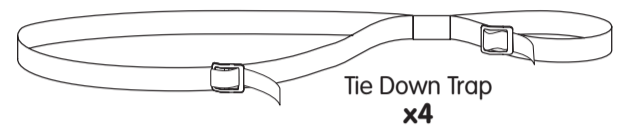

Register your new TP product on line now at
www.tptoys.com/productregistration

Thank you for purchasing this TP product. To find out all about your product guarantee and register your purchase, please visit www.tptoys.com/productregistration

We want to give you the very best service. By registering your purchase now, we will be able to deal with any guarantee issues very quickly and efficiently in the future. Thank you.

Your TP Guarantee Number/Product Batch No is

TP

Robovision Ltd t/a TP Toys Unit 11, Enterprise Way, Flitwick, Bedfordshire, MK45 5BX England
Made in China

For assembly advice, please email directsales@tptoys.com or call 01525 722769 (office hours).

www.tptoys.com



Instruction Part No: IN8075 Issue-A 12.05.17

