













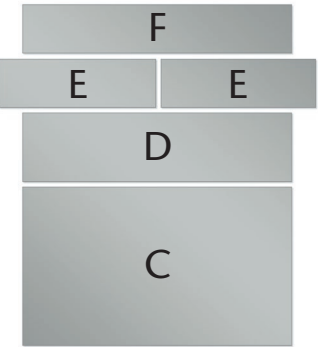

<p><b>16 ×</b></p>  <p>SCHR. 371 6,3 × 12 mm</p>	<p><b>6 ×</b></p>  <p>BESC. 770</p>	<p><b>6 ×</b></p>  <p>SCHR. 370 M5 × 25 mm</p>	<p><b>6 ×</b></p>  <p>BESC. 653</p>		
<p><b>2 ×</b></p>  <p>BESC. 774</p>	<p><b>4 ×</b></p>  <p>SCHR. 412 M4 × 16 mm</p>	<p><b>3 ×</b></p>  <p>SCHR. 413 M4 × 60 mm</p>	<p><b>3 ×</b></p>  <p>BESC. 648</p>		
				<p><b>3 ×</b></p>  <p>BESC. 385</p>	<p>M: 1:1</p> 

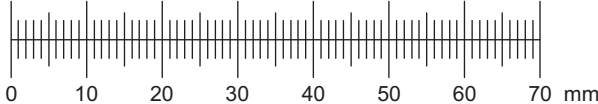
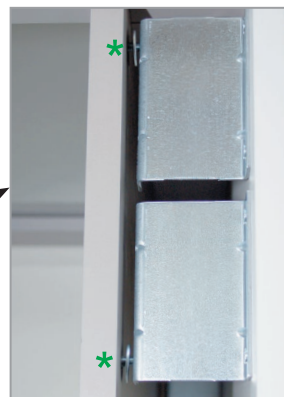
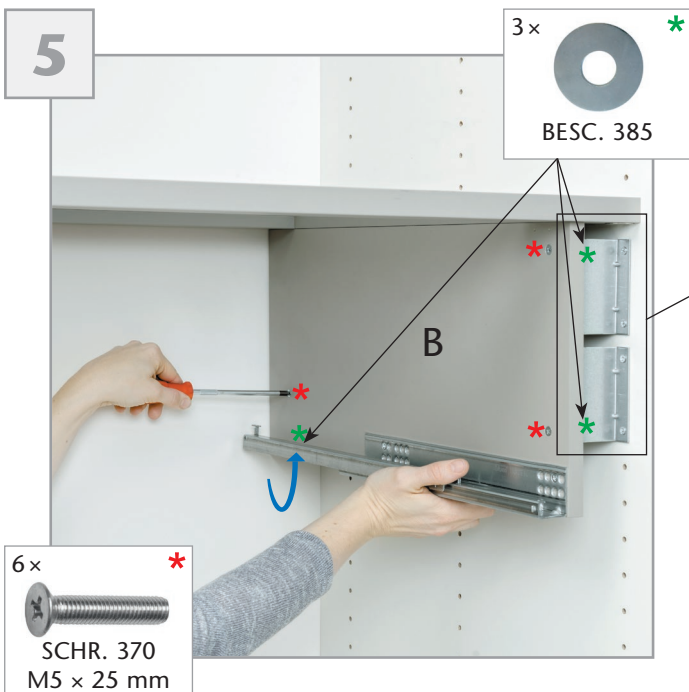
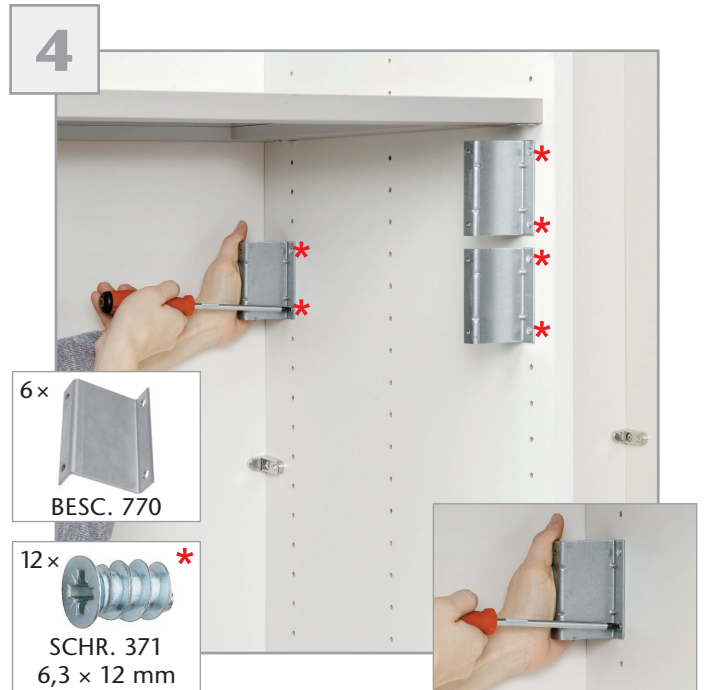
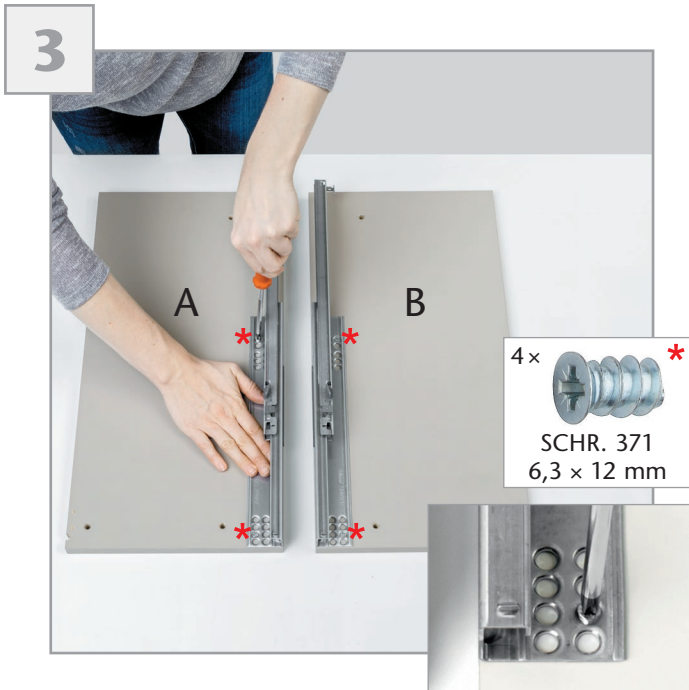
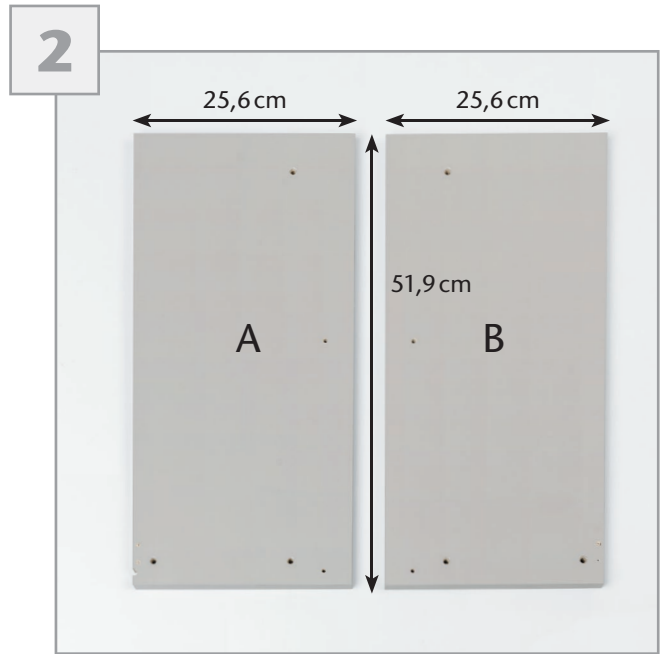

**Wichtig!**  
Ist die Laufeigenschaft der Auszüge nicht optimal, kann dies mit dieser Unterlagscheibe optimiert werden.

**Important!**  
Si le glissement des extensions coulissantes n'est pas optimal, il peut être en utilisant ce supplément.

**Importante!**  
Se lo scorrimento degli elementi estraibili non è ottimale, può essere oltre utilizzando questo supplemento.

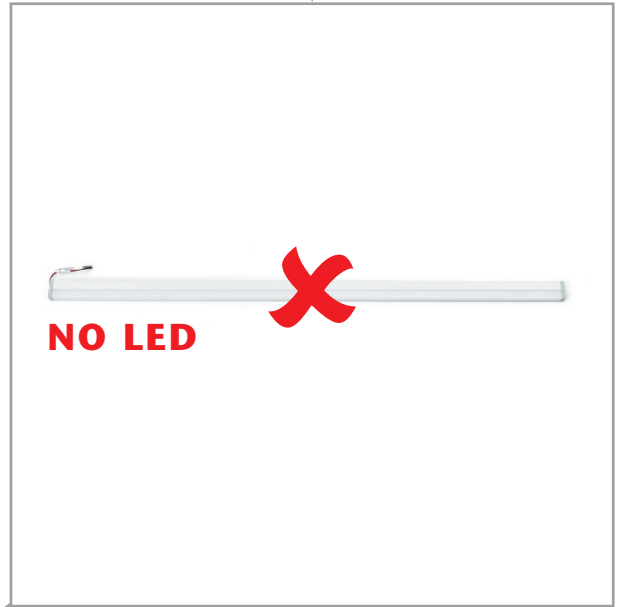
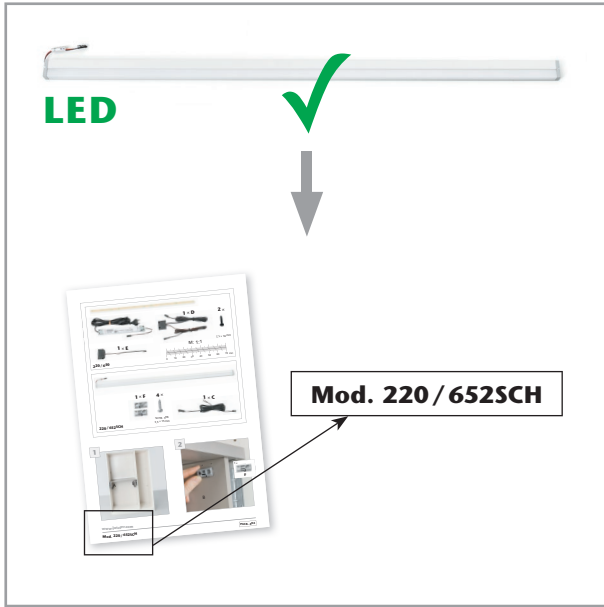

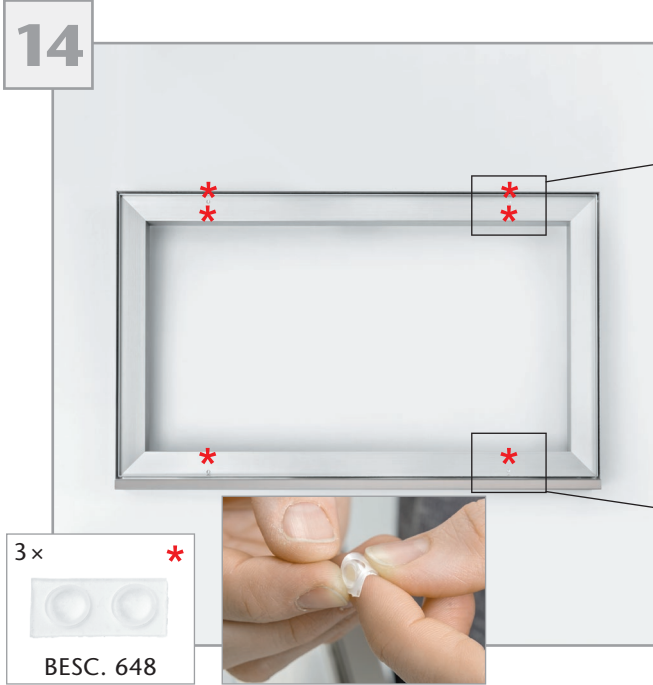
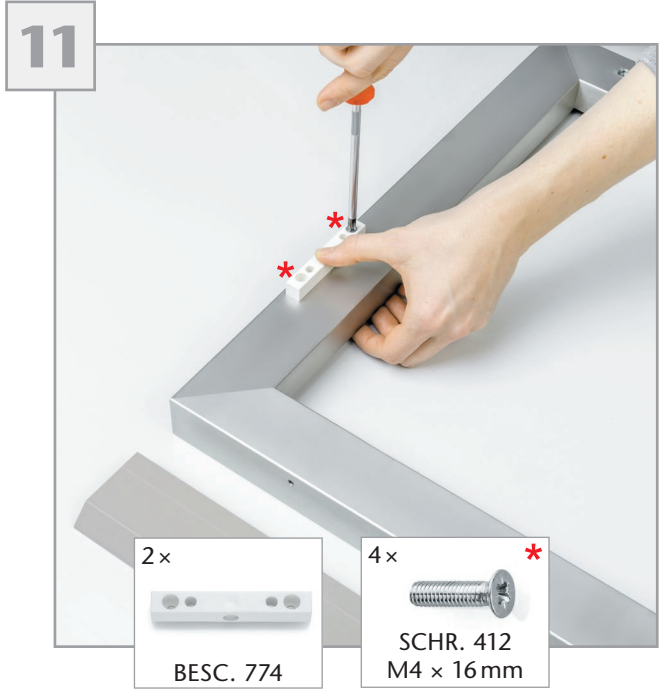

15

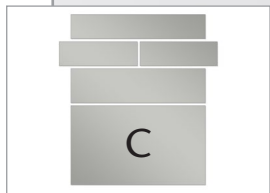

16

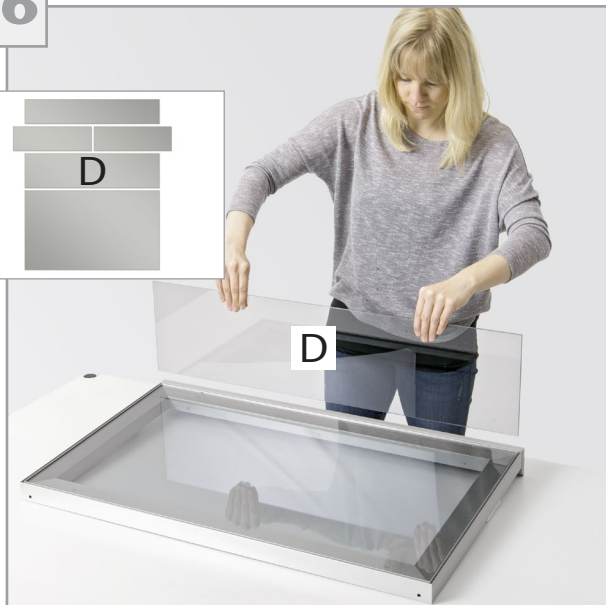
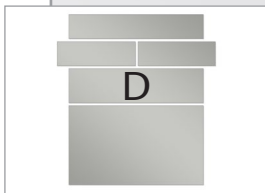

17



18

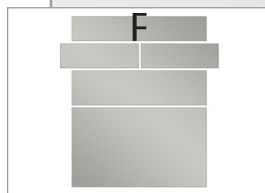

19

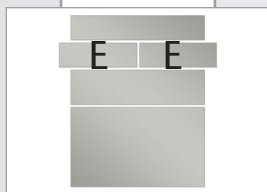

20



21



22



23



24



25



26

